



C:\Users\jg3333\OneDrive\Documents\Projects\1899263\1899263_018\1899263_018_002\1899263_018_002_000.dwg [Plot Date: 2019-07-12 10:44:24 AM]

IF THIS MEASUREMENT DOES NOT MATCH WITH THE SHEET, THE SHEET SIZE SHALL BE USED FOR REFERENCE.

REV.	YYYY-MM-DD	DESCRIPTION	DESIGNED	PREPARED	REVIEWED	APPROVED
1	2019-07-12	ISSUED FOR TENDER	JJP	GPG	WB	GS RPEQ 21434
0	2019-07-05	ISSUED FOR TENDER	JJP	GPG	WB	RJ GS RPEQ 21434

CLIENT
DOUGLAS SHIRE COUNCIL

CONSULTANT
GOLDER
CAIRNS OFFICE
216 DRAPER STREET
CAIRNS, QLD 4870
AUSTRALIA
[+61] (7) 4054 8000
www.golder.com

PROJECT
TREATMENT OF SLOPE INSTABILITIES ON MURPHY STREET,
PORT DOUGLAS

TITLE
SITE LOCALITY PLAN

PROJECT NO. 1899263 CONTROL 018 REV. 1 2 of 17 FIGURE D002

F:\projects\2019\1899263_01_ELEVATION\1899263_01_ELEVATION.dwg | Plot Date: 2019-07-12 10:46:58 AM | Printed By: gpc | Date: 2019-07-12 10:46:58 AM

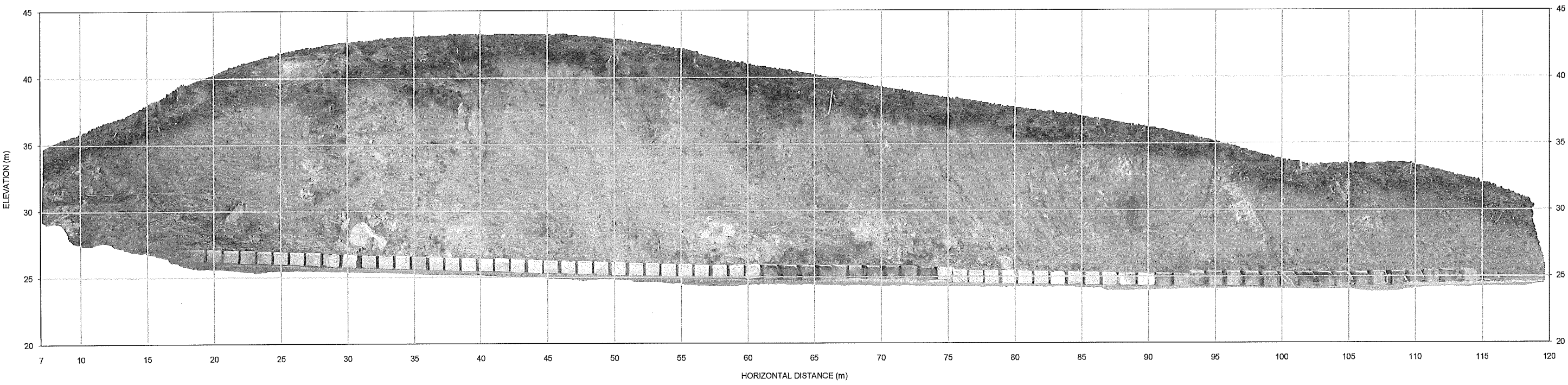

MURPHY ST EAST OF OWEN ST - ELEVATION
 SCALE 1:300 m

ISSUED FOR
TENDER

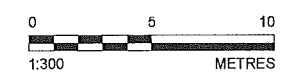

REV.	YYYY-MM-DD	DESCRIPTION	DESIGNED	PREPARED	REVIEWED	APPROVED
1	2019-07-12	ISSUED FOR TENDER	JJP	GPG	WB	GS RPEQ 21434
0	2019-07-05	ISSUED FOR TENDER	JJP	GPG	WB	RJ GS RPEQ 21434

CLIENT
 DOUGLAS SHIRE COUNCIL

CONSULTANT
GOLDER
 CAIRNS OFFICE
 216 DRAPER STREET
 CAIRNS, QLD 4870
 AUSTRALIA
 [+61] (7) 4054 8000
 www.golder.com

PROJECT
 TREATMENT OF SLOPE INSTABILITIES ON MURPHY STREET,
 PORT DOUGLAS

TITLE
MURPHY ST EAST OF OWEN ST - ELEVATION

PROJECT NO. 1899263	CONTROL 018	REV. 1	15 of 17	FIGURE D015
------------------------	----------------	-----------	----------	-----------------------

IF THIS MEASUREMENT DOES NOT MATCH WHAT IS SHOWN ON THE SHEET, THE SHEET SIZE HAS BEEN ADJUSTED FOR SCALE.

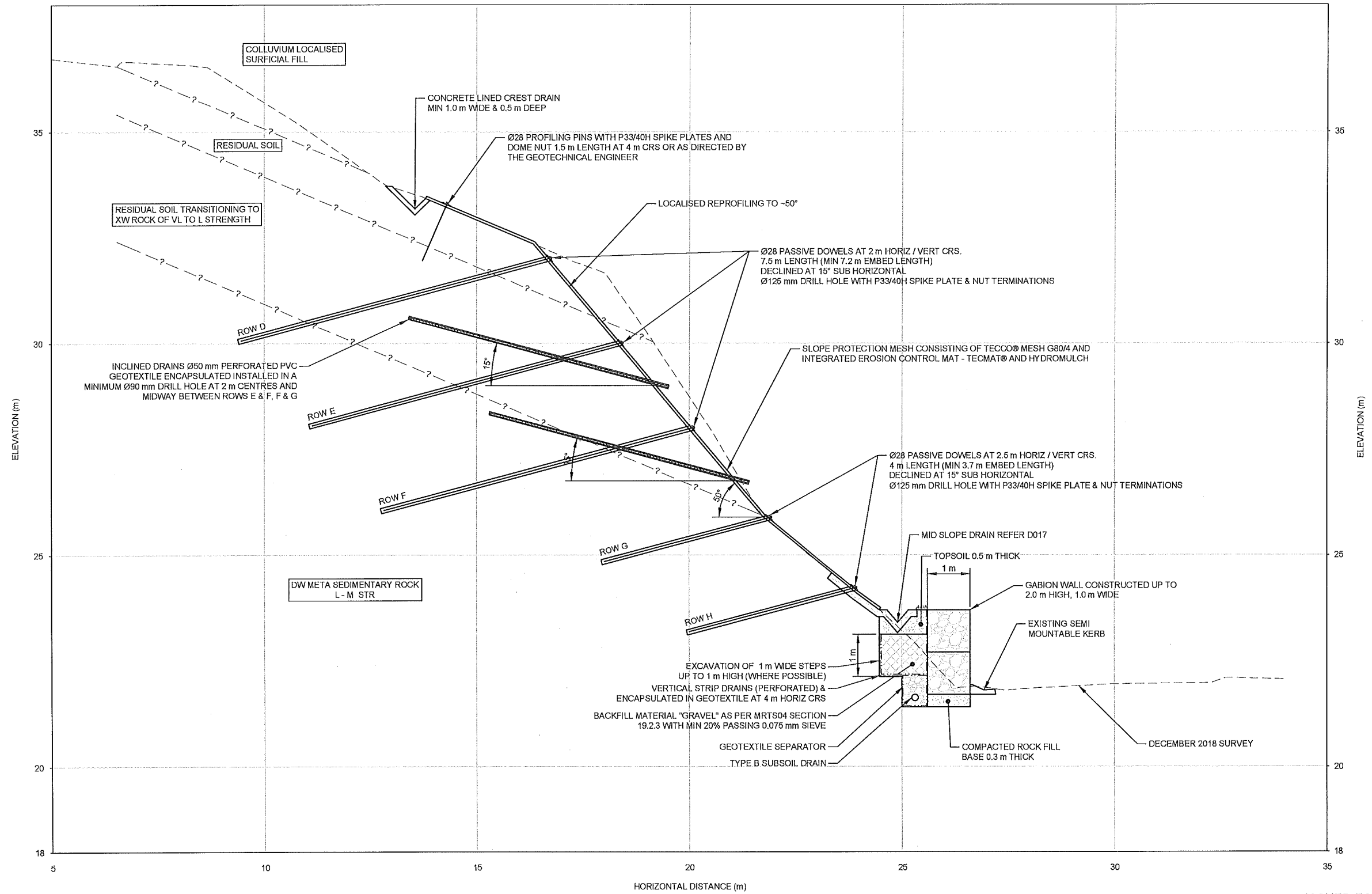

ISSUED FOR
TENDER

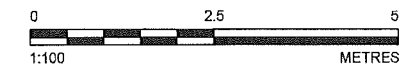

CLIENT
DOUGLAS SHIRE COUNCIL

PROJECT
TREATMENT OF SLOPE INSTABILITIES ON MURPHY STREET,
PORT DOUGLAS

CONSULTANT

CAIRNS OFFICE
216 DRAPER STREET
CAIRNS, QLD 4870
AUSTRALIA
[+61] (7) 4054 8000
www.golder.com

TITLE
MURPHY STREET EAST OF OWEN STREET - TYPICAL
SECTION CH 90

1	2019-07-12	ISSUED FOR TENDER	JJP	GPG	WB	GS RPEQ 21434
0	2019-07-05	ISSUED FOR TENDER	JJP	GPG	WB	R.I. GS RPEQ 21434
REV.	YYYY-MM-DD	DESCRIPTION	DESIGNED	PREPARED	REVIEWED	APPROVED



PROJECT NO.	CONTROL	REV.	14 of 17	FIGURE
1899263	018	1		D014

F:\proj\2019\2019-07-12\1899263\1899263_018\1899263_018_01.dwg | Plot Date: 2019-07-12 | Time: 4:26:21 PM | Printed By: jpp | Plot Scale: 1:100 | Plot Path: F:\proj\2019\2019-07-12\1899263\1899263_018\1899263_018_01.dwg

25 mm IF THIS DRAWING IS USED FOR ANY OTHER PROJECT, THE USER ACCEPTS ALL LIABILITY FOR ANY DAMAGE OR LOSS OF PROFITS.

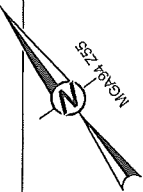
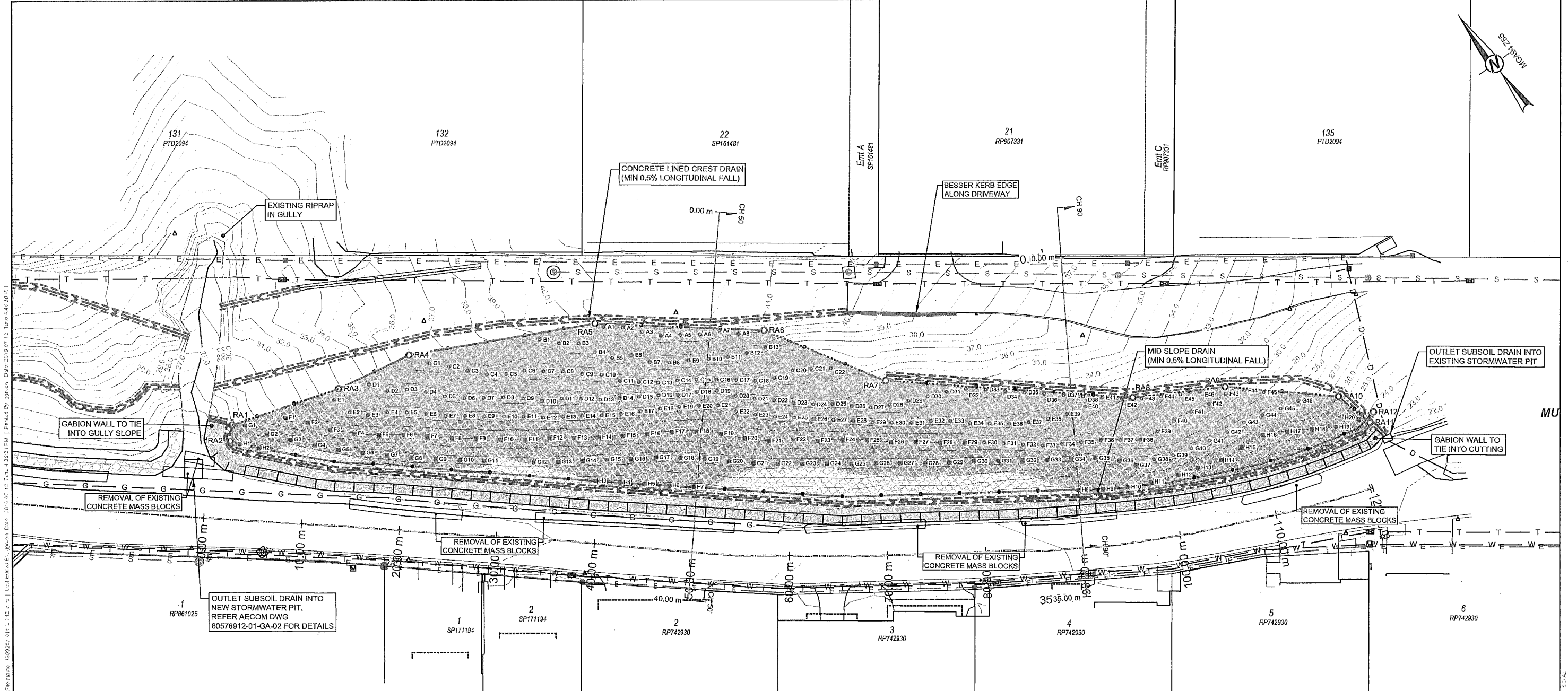

LEGEND

- GABION WALL (2m HIGH)
- ENGINEERED BACKFILL, TOPSOIL AND LANDSCAPE TREATMENT
- PASSIVE DOWELS (MIN. 7.2 m EMBEDMENT LENGTH) AND INTEGRATED SLOPE PROTECTION MESH CONSISTING OF TECCO® MESH G80/4 TECMAT® AND HYDROMULCH
- PASSIVE DOWELS (MIN. 3.7 m EMBEDMENT LENGTH) AND INTEGRATED SLOPE PROTECTION MESH CONSISTING OF TECCO® MESH G80/4 TECMAT® AND HYDROMULCH
- SLOPE PROTECTION MESH CONSISTING OF TECCO® MESH G80/4 - TECMAT® AND HYDROMULCH
- CONCRETE LINED CREST DRAIN
- 4 m LONG Ø28 PASSIVE DOWELS AT 2.5 m HORIZ / VERT CRS (MIN 3.7 m EMBED LENGTH) SLOPE
- 7.5 m LONG Ø28 PASSIVE DOWELS AT 2.0 m HORIZ / VERT CRS (MIN 7.2 m EMBED LENGTH)
- Ø28 mm PROFILING PINS 1.5 m LENGTH AT 4 m CRS
- Ø14 mm PERIMETER ROPE
- Ø28 mm PERIMETER ROPE ANCHORS 3.0 m LENGTH (MIN 2.7 m EMBED LENGTH)

SCHEDULE OF PASSIVE DOWELS (EAST OF OWEN)

Row	Gewi Thread Bar Diameter D (mm)	Ultimate Tensile Strength (kN)	Drill Hole Diameter (mm)/ Drill Angle (Deg.)	Minimum Dowel Embedment Length (m)	Estimated Number of Dowels
A	28	339	125/15	7.2	8
B	28	339	125/15	7.2	13
C	28	339	125/15	7.2	22
D	28	339	125/15	7.2	38
E	28	339	125/15	7.2	46
F-1	28	339	125/15	7.2	16
F-2	28	339	125/15	3.7	29
G-1	28	339	125/15	7.2	9
G-2	28	339	125/15	3.7	37
H	28	339	125/15	3.7	20



ISSUED FOR
TENDER

REV.	YYYY-MM-DD	DESCRIPTION	DESIGNED	PREPARED	REVIEWED	APPROVED
1	2019-07-12	ISSUED FOR TENDER	JJP	GPG	WB	GS RPEQ 21434
0	2019-07-05	ISSUED FOR TENDER	JJP	GPG	WB	RJ GS RPEQ 21434

CLIENT
DOUGLAS SHIRE COUNCIL

CONSULTANT



CAIRNS OFFICE
216 DRAPER STREET
CAIRNS, QLD 4870
AUSTRALIA
+61 (7) 4054 8000
www.golder.com

PROJECT
TREATMENT OF SLOPE INSTABILITIES ON MURPHY STREET,
PORT DOUGLAS

TITLE
MURPHY STREET EAST OF OWEN STREET - SITE PLAN

PROJECT NO.	CONTROL	REV.	12 of 17	FIGURE
1899263	018	1		D012

File Name: \\gis\apps\2019\1899263\1899263_018\1899263_018_001\MURPHY_STREET\PROJECTIONS\MURPHY_STREET\PROJECTIONS\MURPHY_STREET_018_001_001.dwg | Plot Date: 2019/07/12 | Time: 4:25:05 PM | Plotter: HP DesignJet 2550 | Paper Size: A3 | Scale: 1:150 | Orientation: Landscape | Plot Area: 0.000000 | Plot Device: HP DesignJet 2550 | Plot Driver: HP DesignJet 2550 | Plot Method: PLOT | Plot Status: Success

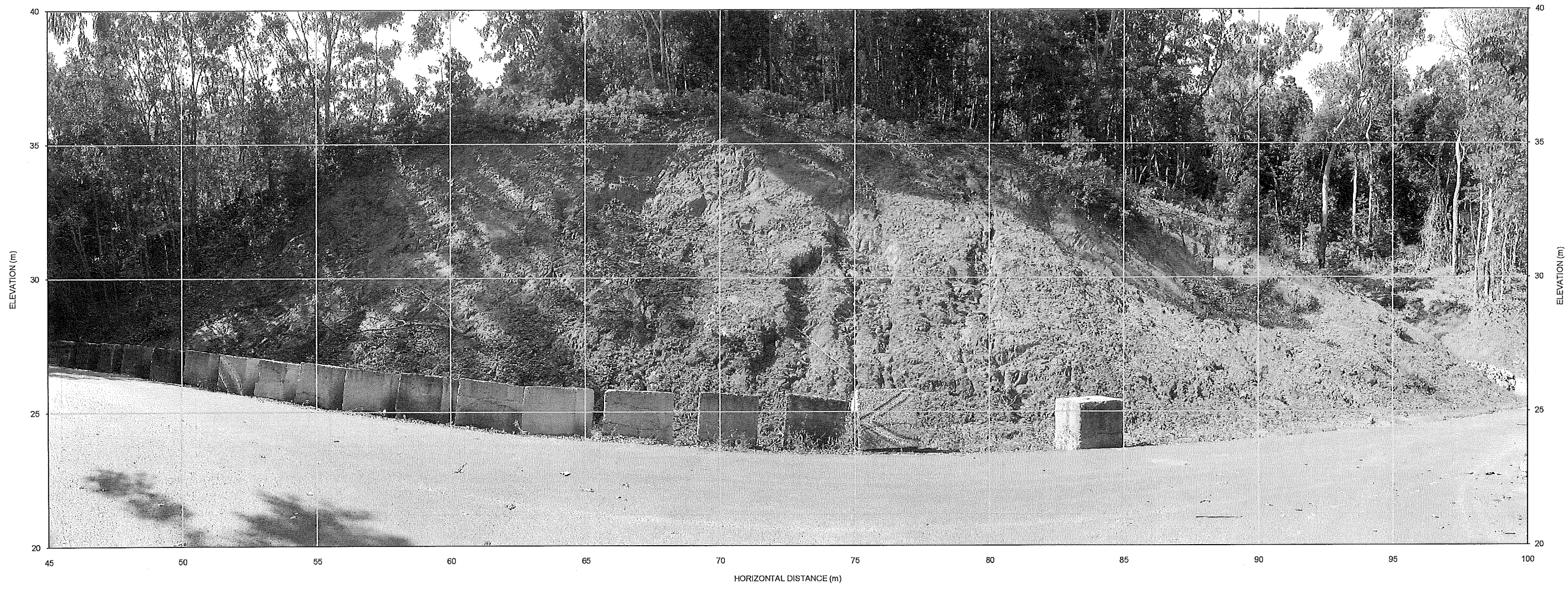

MURPHY STREET – OWEN STREET - ELEVATION
 SCALE 1:150 m

ISSUED FOR
TENDER

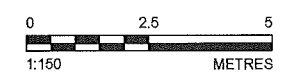

REV.	YYYY-MM-DD	DESCRIPTION	DESIGNED	PREPARED	REVIEWED	APPROVED
1	2019-07-12	ISSUED FOR TENDER	JJP	GPG	WB	GS RPEQ 21434
0	2019-07-05	ISSUED FOR TENDER	JJP	GPG	WB	RJ GS RPEQ 21434

CLIENT
DOUGLAS SHIRE COUNCIL

PROJECT
**TREATMENT OF SLOPE INSTABILITIES ON MURPHY STREET,
 PORT DOUGLAS**

CONSULTANT
GOLDER
 CAIRNS OFFICE
 216 DRAPER STREET
 CAIRNS, QLD 4870
 AUSTRALIA
 [+61] (7) 4054 8000
 www.golder.com

TITLE
MURPHY STREET – OWEN STREET - ELEVATION

PROJECT NO.	CONTROL	REV.	11 of 17	FIGURE
1899263	018	1		D011

IF THIS MEASUREMENT DOES NOT MATCH WITH A SIGNIFICANT DIFFERENCE, THE SHEET SIZE HAS BEEN USED AS REFERENCE.

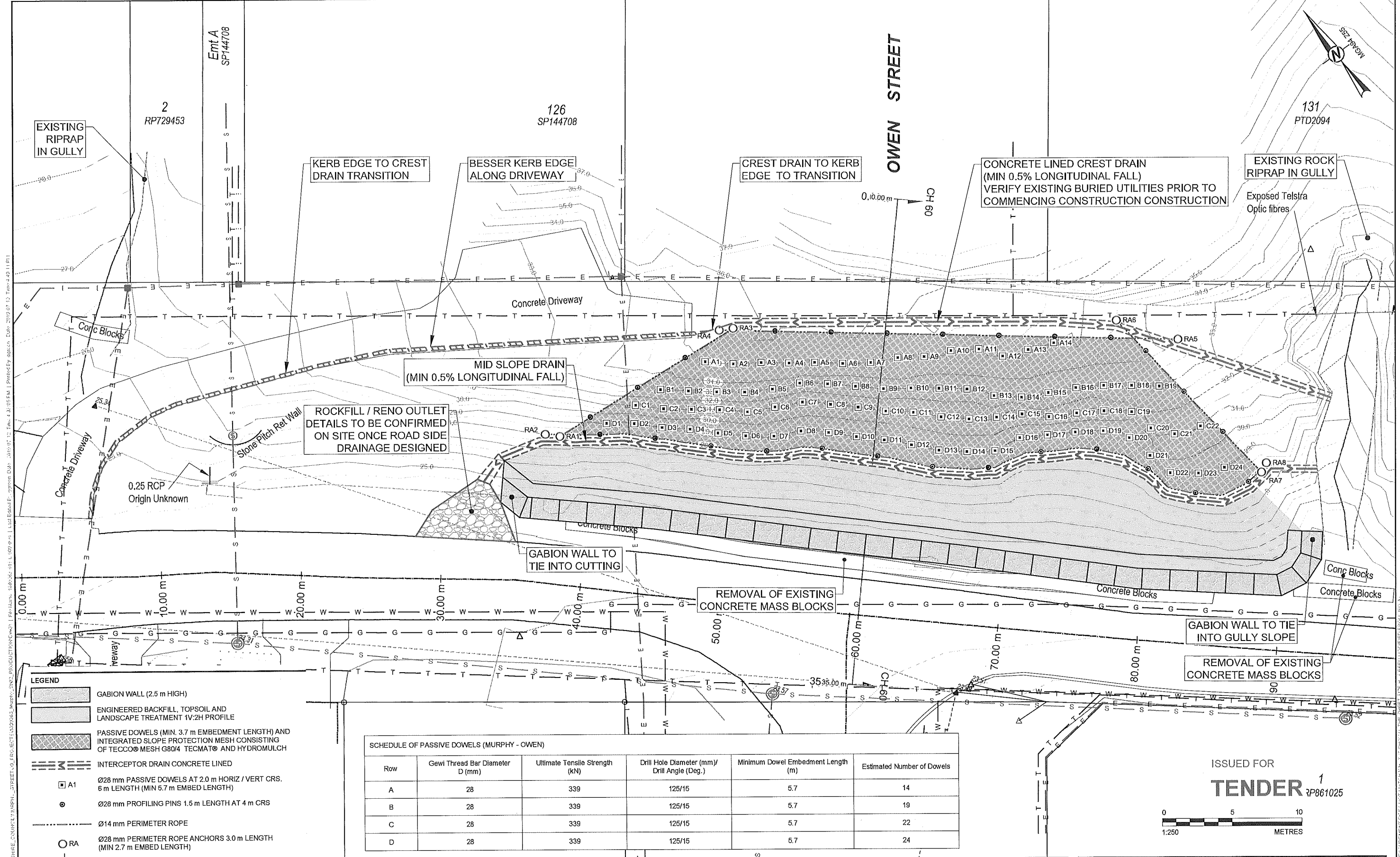

1. 2019-07-12 ISSUED FOR TENDER JJP GPG WB GS RPEQ 21434
 0. 2019-07-05 ISSUED FOR TENDER JJP GPG WB RJ GS RPEQ 21434
 REV. YYYY-MM-DD DESCRIPTION DESIGNED PREPARED REVIEWED APPROVED

CLIENT
DOUGLAS SHIRE COUNCIL

CONSULTANT
GOLDER
CAIRNS OFFICE
216 DRAPER STREET
CAIRNS, QLD 4870
AUSTRALIA
[+61] (7) 4054 8000
www.golder.com

PROJECT
TREATMENT OF SLOPE INSTABILITIES ON MURPHY STREET,
PORT DOUGLAS

TITLE
MURPHY STREET - OWEN STREET INTERSECTION - SITE PLAN

PROJECT NO. 1899263 CONTROL 018 REV. 1 9 of 17 FIGURE D009

ISSUED FOR
TENDER 1
RP861025



File Name: 180060_01_L 08 of 9 | Last Edited: 2019-07-12 | File Path: C:\Users\jmurphy\Documents\Projects\180060_01_L 08 of 9 | Last Edited: 2019-07-12 | File Name: 180060_01_L 08 of 9 | Last Edited: 2019-07-12 | File Path: C:\Users\jmurphy\Documents\Projects\180060_01_L 08 of 9 | Last Edited: 2019-07-12

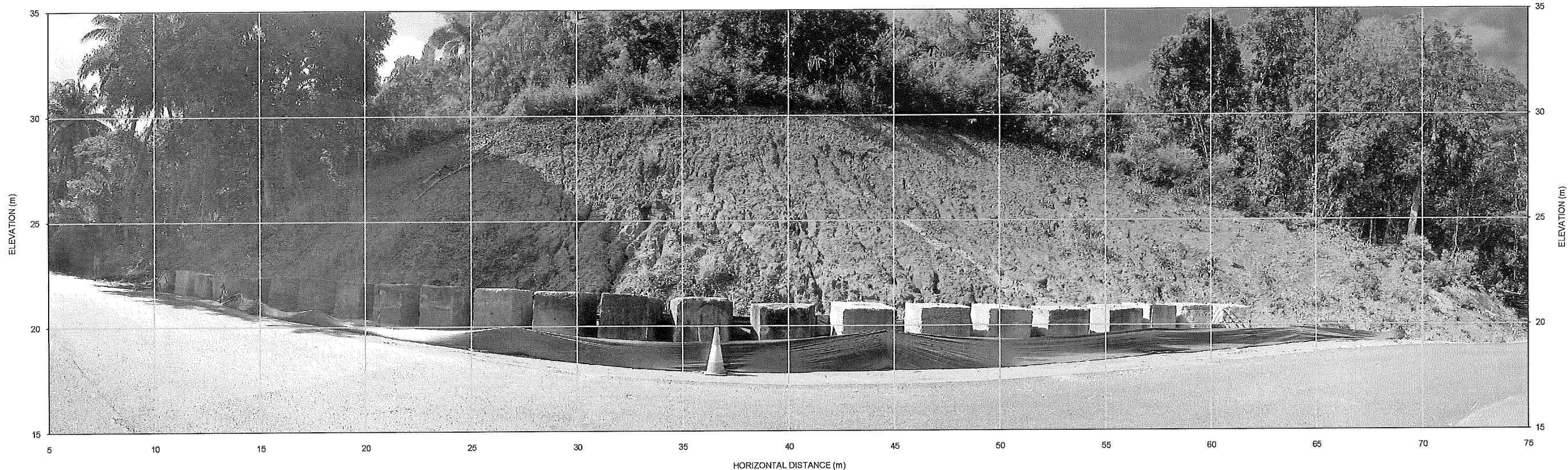

MURPHY ST – GRANT ST INTERSECTION - ELEVATION
SCALE 1:200 m

ISSUED FOR
TENDER

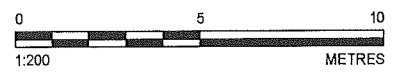

REV.	YYYY-MM-DD	DESCRIPTION	DESIGNED	PREPARED	REVIEWED	APPROVED
1	2019-07-12	ISSUED FOR TENDER	JJP	GPG	WB	GS RPEQ 21434
0	2019-07-05	ISSUED FOR TENDER	JJP	GPG	WB	RJ GS RPEQ 21434

CLIENT
DOUGLAS SHIRE COUNCIL

CONSULTANT
GOLDER
CAIRNS OFFICE
216 DRAPER STREET
CAIRNS, QLD 4870
AUSTRALIA
[+61] (7) 4054 8000
www.golder.com

PROJECT
TREATMENT OF SLOPE INSTABILITIES ON MURPHY STREET,
PORT DOUGLAS

TITLE
MURPHY ST – GRANT ST INTERSECTION - ELEVATION

PROJECT NO. 1899263 CONTROL 018 REV. 1 8 of 17 FIGURE D008

20 mm IF THIS MEASUREMENT DOES NOT MATCH WITH THE SHEET SCALE PLEASE REFER TO THE PROJECT DRAWINGS

CH 40

CH 40'

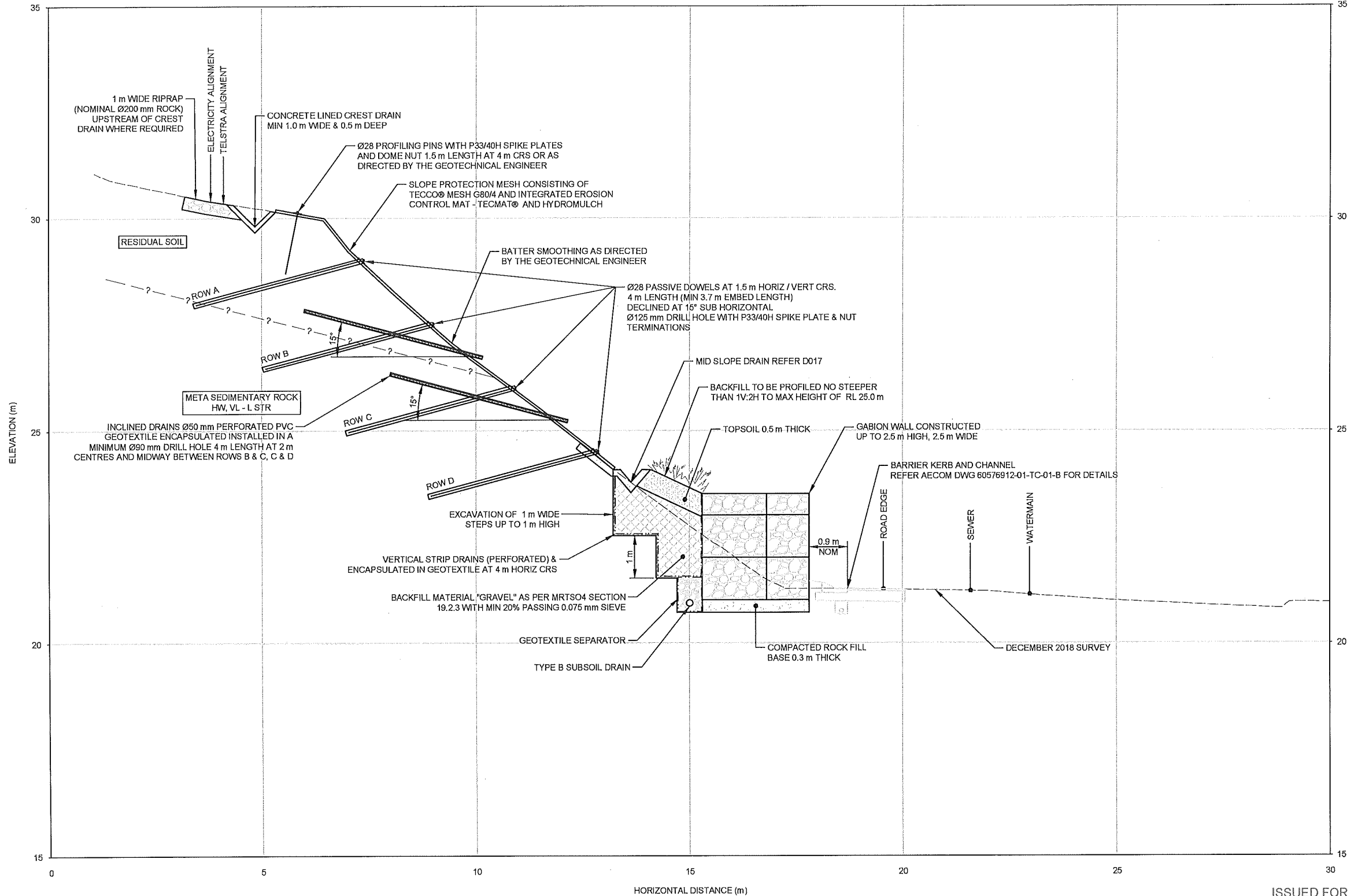

ISSUED FOR
TENDER

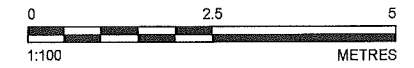

CLIENT
DOUGLAS SHIRE COUNCIL

PROJECT
TREATMENT OF SLOPE INSTABILITIES ON MURPHY STREET,
PORT DOUGLAS

CONSULTANT

CAIRNS OFFICE
216 DRAPER STREET
CAIRNS, QLD 4870
AUSTRALIA
[+61] (7) 4054 8000
www.golder.com

TITLE
**MURPHY STREET – GRANT STREET INTERSECTION -
TYPICAL SECTION CH 40**

1	2019-07-12	ISSUED FOR TENDER	JJP	GPG	WB	GS RPEQ 21434
0	2019-07-05	ISSUED FOR TENDER	JJP	GPG	WB	RJ GS RPEQ 21434



PROJECT NO. 1899263	CONTROL 018	REV. 1	7 of 17	FIGURE D007
------------------------	----------------	-----------	---------	----------------

P:\2019\1899263\1899263-018\1899263-018-TYPICAL SECTION CH 40.dwg | Issue 01 | Date: 2019-07-12 | Time: 10:05:11 AM | Project: 1899263 | User: jpp | Plot: 1899263-018-TYPICAL SECTION CH 40.dwg | Scale: 1:100 | Sheet: 1 of 17

IF THIS MEASUREMENT DOES NOT MATCH WITH THE SURVEY, THE SHEET SIZE HAS BEEN ADJUSTED FOR PRINTING.

5
RP747683

NOTE(S)
1. PLAN BASED ON INFORMATION FROM DRAWINGS PR140637-1a AND PR140637-2. PROVIDED BY CLIENT.

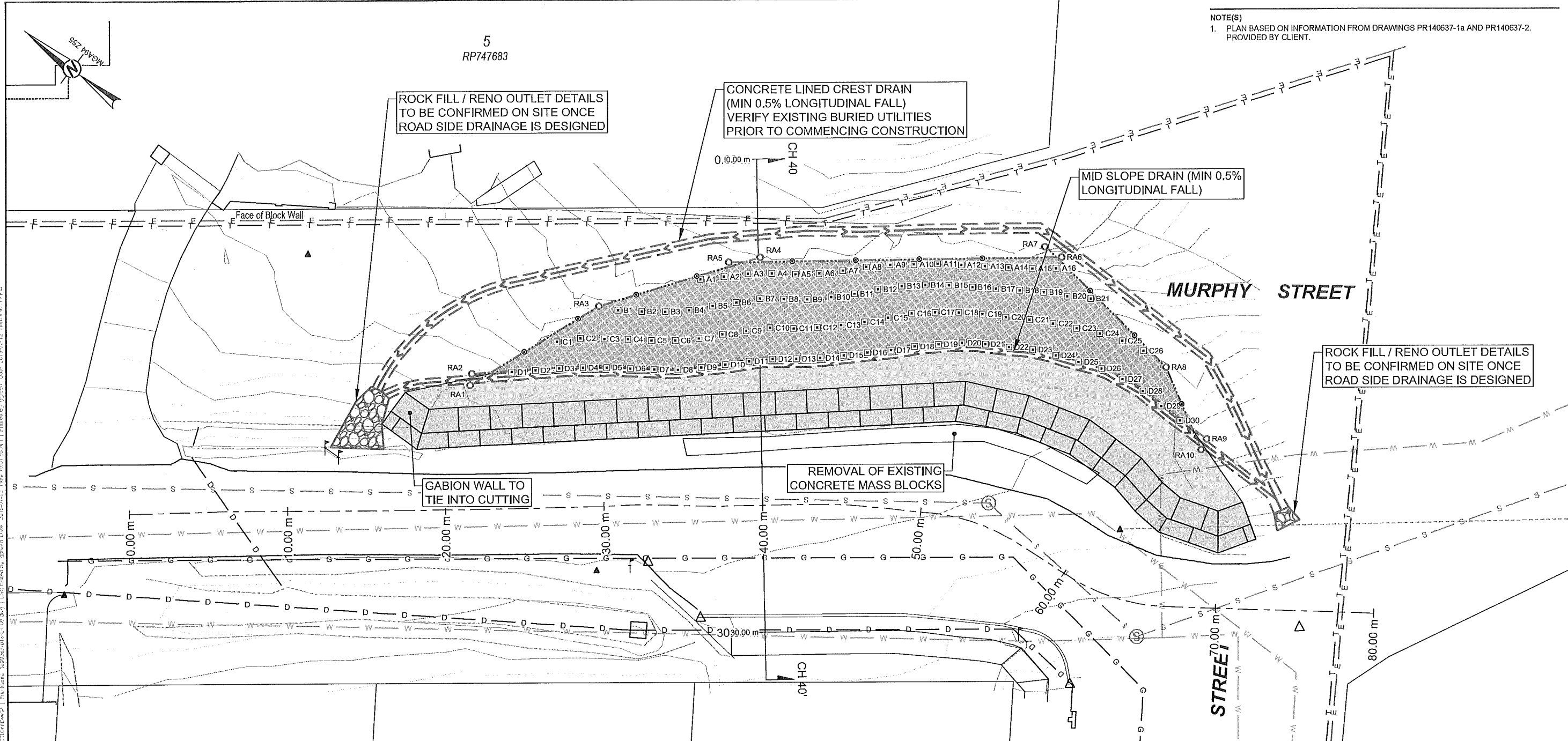

GABION WALL TO TIE INTO CUTTING

CONCRETE LINED CREST DRAIN (MIN 0.5% LONGITUDINAL FALL) VERIFY EXISTING BURIED UTILITIES PRIOR TO COMMENCING CONSTRUCTION

MID SLOPE DRAIN (MIN 0.5% LONGITUDINAL FALL)

ROCK FILL / RENO OUTLET DETAILS TO BE CONFIRMED ON SITE ONCE ROAD SIDE DRAINAGE IS DESIGNED

REMOVAL OF EXISTING CONCRETE MASS BLOCKS

- LEGEND**
- GABION WALL (2.5 m HIGH)
 - ENGINEERED BACKFILL, TOPSOIL AND LANDSCAPE TREATMENT 1V:2H PROFILE
 - PASSIVE DOWELS (MIN. 3.7 m EMBEDMENT LENGTH) AND INTEGRATED SLOPE PROTECTION MESH CONSISTING OF TECCO® MESH G80/4 TECCAT® AND HYDROMULCH
 - PROPOSED CONCRETE LINED INTERCEPTOR DRAIN
 - A1 Ø28 mm PASSIVE DOWELS AT 1.5 m HORIZ / VERT CRS. 4 m LENGTH (MIN 3.7 m EMBED LENGTH)
 - Ø28 mm PROFILING PINS 1.5 m LENGTH AT 4 m CRS
 - Ø14 mm PERIMETER ROPE
 - RA Ø28 mm PERIMETER ROPE ANCHORS 3.0 m LENGTH (MIN 2.7 m EMBED LENGTH)

SCHEDULE OF PASSIVE DOWELS (MURPHY - GRANT)

Row	Gewi Thread Bar Diameter D (mm)	Ultimate Tensile Strength (kN)	Drill Hole Diameter (mm)/ Drill Angle (Deg.)	Minimum Dowel Embedment Length (m)	Estimated Number of Dowels
A	28	339	125/15	3.7	16
B	28	339	125/15	3.7	21
C	28	339	125/15	3.7	26
D	28	339	125/15	3.7	30

113
PTD2091

1
SP215434

ISSUED FOR
TENDER

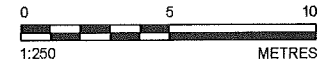

CLIENT
DOUGLAS SHIRE COUNCIL

PROJECT
TREATMENT OF SLOPE INSTABILITIES ON MURPHY STREET, PORT DOUGLAS

CONSULTANT

CAIRNS OFFICE
216 DRAPER STREET
CAIRNS, QLD 4870
AUSTRALIA
+61 (7) 4054 8000
www.golder.com

TITLE
MURPHY STREET - GRANT STREET INTERSECTION - SITE PLAN



REV.	YYYY-MM-DD	DESCRIPTION	DESIGNED	PREPARED	REVIEWED	APPROVED
1	2019-07-12	ISSUED FOR TENDER	JJP	GPG	WB	GS RPEQ 21434
0	2019-07-05	ISSUED FOR TENDER	JJP	GPG	WB	RJ GS RPEQ 21434

PROJECT NO. 1899263 CONTROL 018 REV. 1 of 17 FIGURE D006