

FNQROC STANDARD SPECIFICATIONS:

- S1 EARTHWORKS
- S2 ROAD PAVEMENTS
- S4 STORMWATER DRAINAGE
- S5 WATER RETICULATION
- S6 SEWERAGE RETICULATION
- S7 CONCRETE WORKS
- S8 LANDSCAPING

FNQROC STANDARD DRAWINGS:

- S1000 CONCRETE KERB & CHANNEL PROFILES & DIMENSIONS
- S1015 ACCESS CROSSOVERS
- S1035 PATHWAYS / BIKEWAYS
- S1045 EXCAVATION, BEDDING AND BACKFILLING OF PRECAST BOX CULVERTS
- S1080 BOX CULVERT HEADWALL - H 150mm TO 600mm
- S1110 CONCRETE DRIVEWAY FOR ALLOTMENT ACCESS
- S2005 HYDRANT BOX INSTALLATION
- S2010 KERB / ROAD MARKERS
- S2011 STEEL MARKER POSTS
- S2016 WATER RETICULATION BEDDING DETAILS
- S2020 MAIN CONNECTION DETAILS

NOTES:

1. FOR LANDSCAPE DETAILS REFER LANDSCAPE DWG No. SK02 BY SITE PLAN
2. REFUSE BIN AREA TO HAVE CONCRETE SLAB, SCREEN FENCE, HOSE COCK AND FOX DIVERSION VALVE TO SEWERAGE SYSTEM.
3. CLEARING OF TREES ONSITE SHALL COMPLY WITH THE EXISTING PERMIT, HOWEVER NO TREES WITHIN ROAD RESERVES SHALL BE REMOVED

POINT	EASTING	NORTHING	LEVELS
1	1720.142	1079.517	FS5.00
2	1734.131	1079.862	FS5.71
3	1734.924	1066.084	FS5.50
4	1736.435	1064.672	FS5.52
5	1736.838	1057.677	FS5.45
6	1735.500	1056.101	FS5.43
7	1736.439	1039.793	FS5.20
8	1717.657	1038.711	FS5.43
9	1714.635	1039.840	FS5.48
10	1698.945	1055.135	FS5.90
11	1701.995	1058.262	FS6.00
12	1701.977	1059.676	FS6.10
13	1706.166	1063.972	FS6.12
14	1707.400	1062.994	FS6.12
15	1708.889	1062.481	FS6.10
16	1712.483	1062.688	FS6.10
17	1712.448	1063.287	FS6.11
18	1728.022	1064.184	FS5.70
19	1728.963	1065.240	FS5.70
20	1748.675	1056.191	LL5.13
21	1748.113	1066.555	LL5.16
22	1749.690	1039.558	LL5.09
23	1752.697	1034.838	RL5.18
24	1746.491	1095.099	LL5.23
25	1748.179	1100.210	RL5.29
26	1753.947	1117.122	-
27	1758.128	1092.461	-
28	1760.353	1062.540	-
29	1761.706	1047.593	-
30	1764.288	1022.700	-
31	1718.971	1050.908	FS5.66
32	1729.753	1051.529	FS5.50
33	1745.055	1057.452	IL4.62
34	1744.571	1065.838	IL4.68
35	1742.345	1039.288	IL4.55
36	1750.093	1120.045	-
37	1756.962	1093.585	-
38	1752.904	1080.144	-
39	1753.748	1068.174	-
40	1742.903	1094.143	IL5.78
41	1743.041	1091.751	IL5.77

LEGEND

- ROAD WIDENING - 30mm DG10 ASPHALT
125mm CBR 60 TYPE 2.2
125mm CBR 45 TYPE 2.3
- CONCRETE CARPARK REFER C02 FOR DETAILS
- BITUMEN FOOTPATH WITH CONCRETE EDGE RESTRAINTS
- MULCHED GARDEN BEDS
- ALL EXISTING TREES TO REMAIN IN THIS AREA
- NEW TURFED AREA
- CONCRETE FOOTPATH
- NEW WATER MAIN CROSSING WITH NEW DOUBLE HEAD PILLAR HYDRANT INSTALLED IN ACCORDANCE WITH AS24.19.1. PROTECT WITH BOLLARDS.
- EXISTING WATER MAIN
- EXIST SEWER MAIN
- NATURAL SURFACE LEVEL
- NEW BOLLARD LIGHTING AT ENTRANCE

THE CONTRACTOR SHALL DETERMINE THE CORRECT LOCATIONS OF ALL EXISTING SERVICES ON SITE PRIOR TO COMMENCEMENT OF WORKS IN CONJUNCTION WITH THE RELEVANT SERVICE PROVIDER.

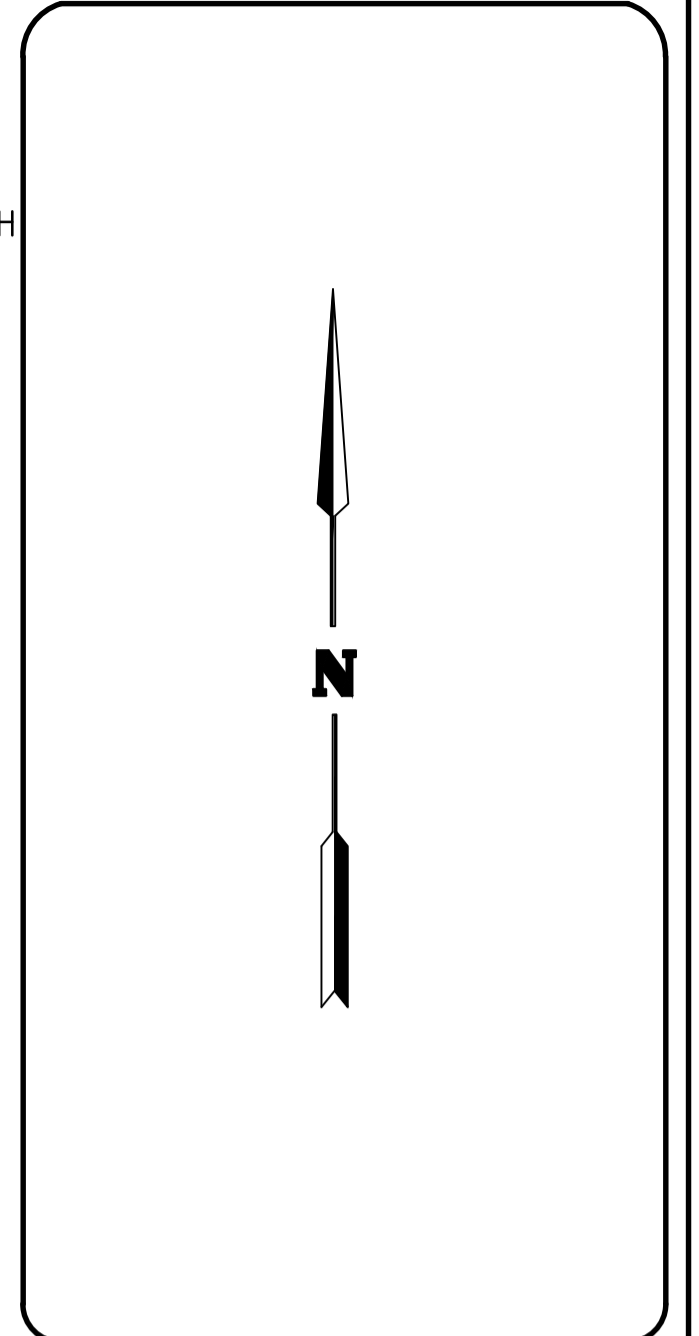
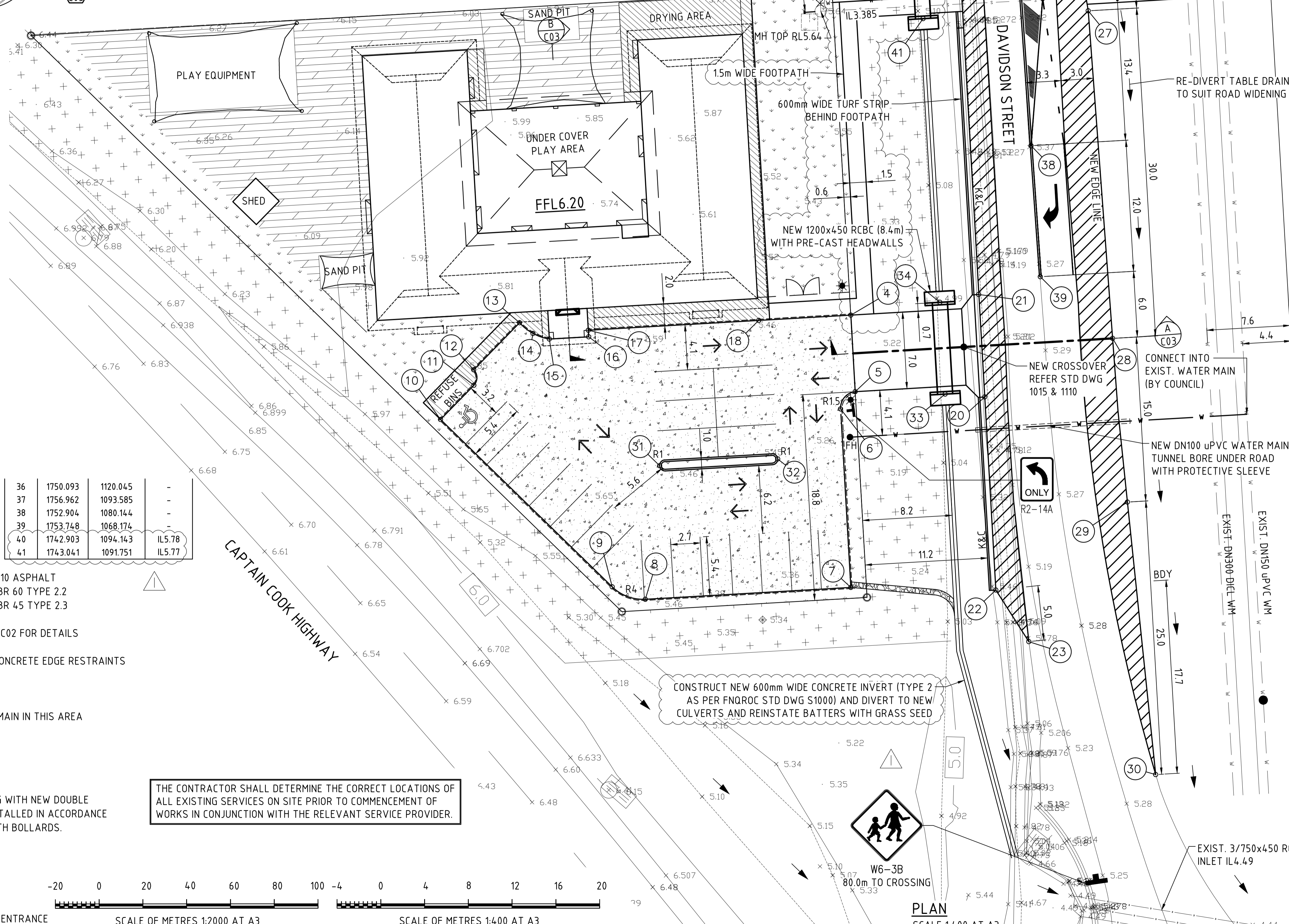
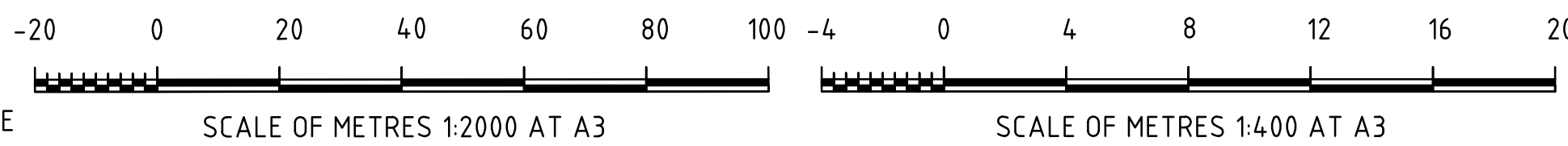

REVISION	APPD	DATE
A	LCJ	09/10/07
B	PWE	14/05/08
C	LCJ	17/06/08
D	PWE	06/02/12
E	PAV	16/04/12
F	DEJ	07/06/12
G	DEJ	25/06/12
H	DEJ	17/07/12

FOR APPROVAL

© COPYRIGHT
THIS DOCUMENT IS AND SHALL REMAIN THE PROPERTY OF LCJ ENGINEERS PTY LTD. THE DOCUMENT MAY ONLY BE USED FOR THE PURPOSE FOR WHICH IT WAS COMMISSIONED AND IN ACCORDANCE WITH THE TERMS OF ENGAGEMENT FOR THE COMMISSION. UNAUTHORISED USE OF THIS DOCUMENT IN ANY WAY IS PROHIBITED.

LCJ ENGINEERS

LCJ Engineers Pty Ltd
ABN 66 196 373 875
601 Flinders Street PO Box 1498
Townsville QLD 4810 Aitkenvale QLD 4814
T 07 4721 5800 F 07 4721 5900
townsville@lcjengineers.com.au
www.lcjengineers.com.au

CAD FILE NAMES	

DRAWN	DESIGNED
OFC	PWE
APPROVED	DATE
L.C. JOHNSTONE	09.10.07

CLIENT
TAYLOR HOMES

PROJECT
PORT DOUGLAS CHILDCARE CENTRE

LOT 2 ON C2256 - CNR CAPTAIN COOK HIGHWAY AND DAVIDSON ST

DRAWING
CARPARK LAYOUT AND DETAILS

NUMBER	SHEET NO.	REVISION
TAY14101	C01	I

PLAN
SCALE 1:400 AT A3

LEGEND

- S.J. — SAWCUT JOINT REFER DWG C03 FOR DETAIL
- - - D.C.J. - - - DOWELED CONSTRUCTION JOINT REFER DWG C03 FOR DETAIL
- ==== RUP ==== ROLL-UP KERB REFER DWG C03 FOR DETAIL

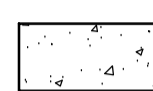
 125mm THICK N32 CONCRETE U.N.O
 1 LAYER SL82 MESH 30mm COVER U.N.O
 50mm CRUSHER DUST LAYER
 250mm IMPORTED FILL WORKING PLATFORM CBR15 MIN.
 GEOFABRIC (BIDIM A34 OR EQUIV.)

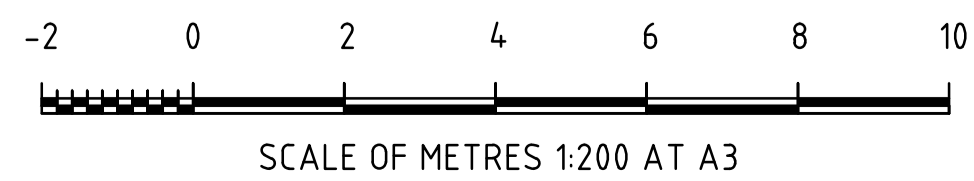
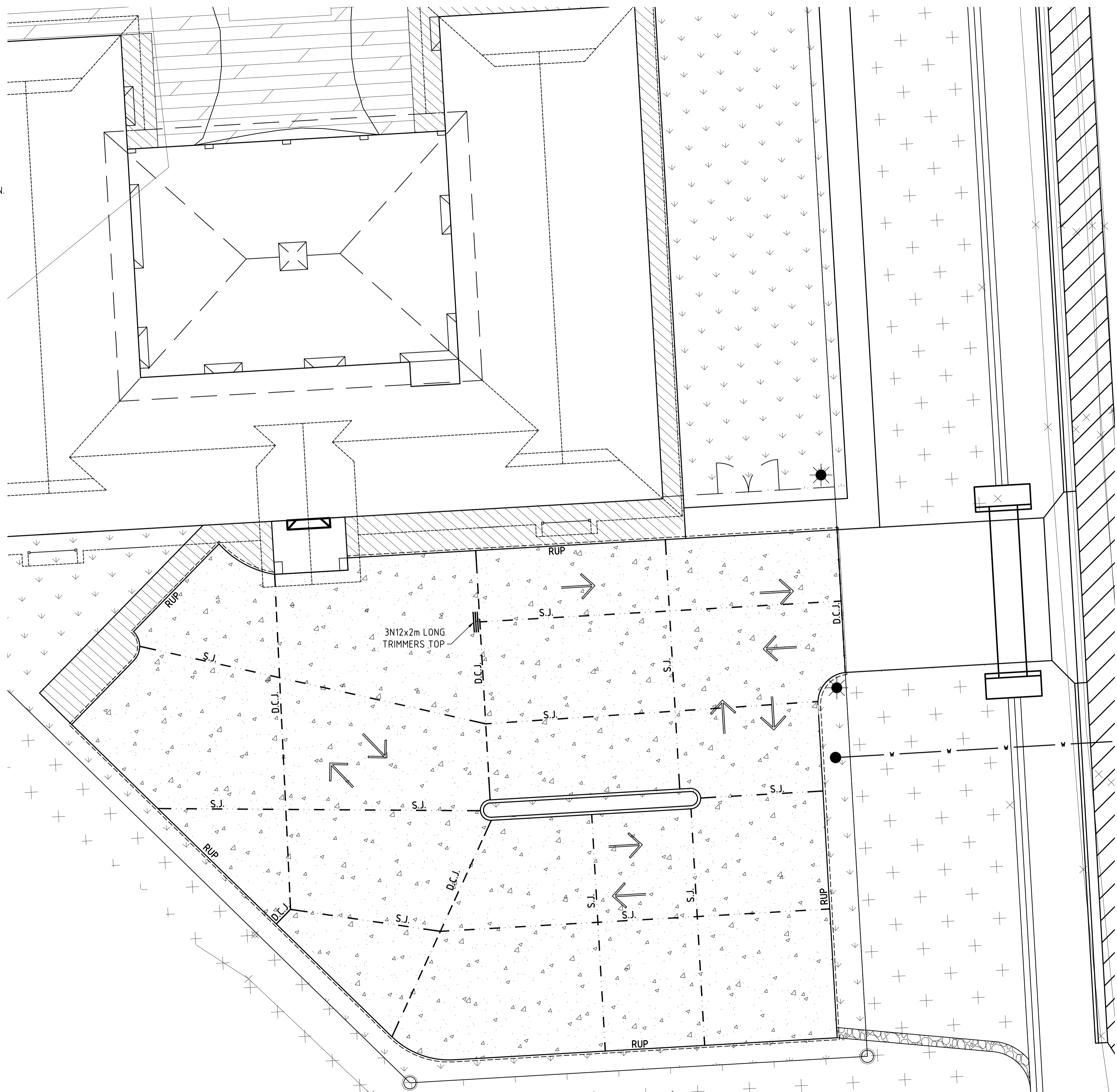

PLAN
SCALE 1:200 AT A3



REVISION	APP'D	DATE
F FOR APPROVAL		
E FOOTPATH ADDED	DEJ	07/06/12
D PATHWAYS & CULVERT AMENDED	PAV	16.04.12
C CARPARKS REMOVED	--	06/02/12
B INFO REQ 21/5/2008	LCJ	17.06.08
A ORIGINAL ISSUE	LCJ	09.10.07

FOR APPROVAL

© COPYRIGHT
THIS DOCUMENT IS AND SHALL REMAIN THE PROPERTY OF LCJ ENGINEERS PTY LTD. THE DOCUMENT MAY ONLY BE USED FOR THE PURPOSE FOR WHICH IT WAS COMMISSIONED AND IN ACCORDANCE WITH THE TERMS OF ENGAGEMENT FOR THE COMMISSION. UNAUTHORISED USE OF THIS DOCUMENT IN ANY WAY IS PROHIBITED.

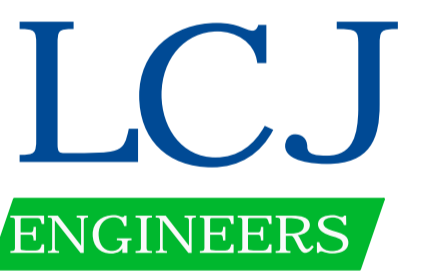

LCJ Engineers Pty Ltd
 ABN 66 196 373 875
 601 Flinders Street PO Box 1498
 Townsville QLD 4810 Aitkenvale QLD 4814
 T 07 4721 5800 F 07 4721 5900
 townsville@lcjengineers.com.au
 www.lcjengineers.com.au

CAD FILE NAMES	
DRAWN OFC	DESIGNED PWE
APPROVED L.C. JOHNSTONE	DATE 09.10.07

CLIENT
 TAYLOR HOMES

PROJECT
 PORT DOUGLAS CHILDCARE CENTRE

 LOT 2 ON C2256 - CNR CAPTAIN COOK HIGHWAY AND DAVIDSON ST

DRAWING
 CONSTRUCTION DETAILS

NUMBER	SHEET NO.	REVISION
TAY14101	C02	F

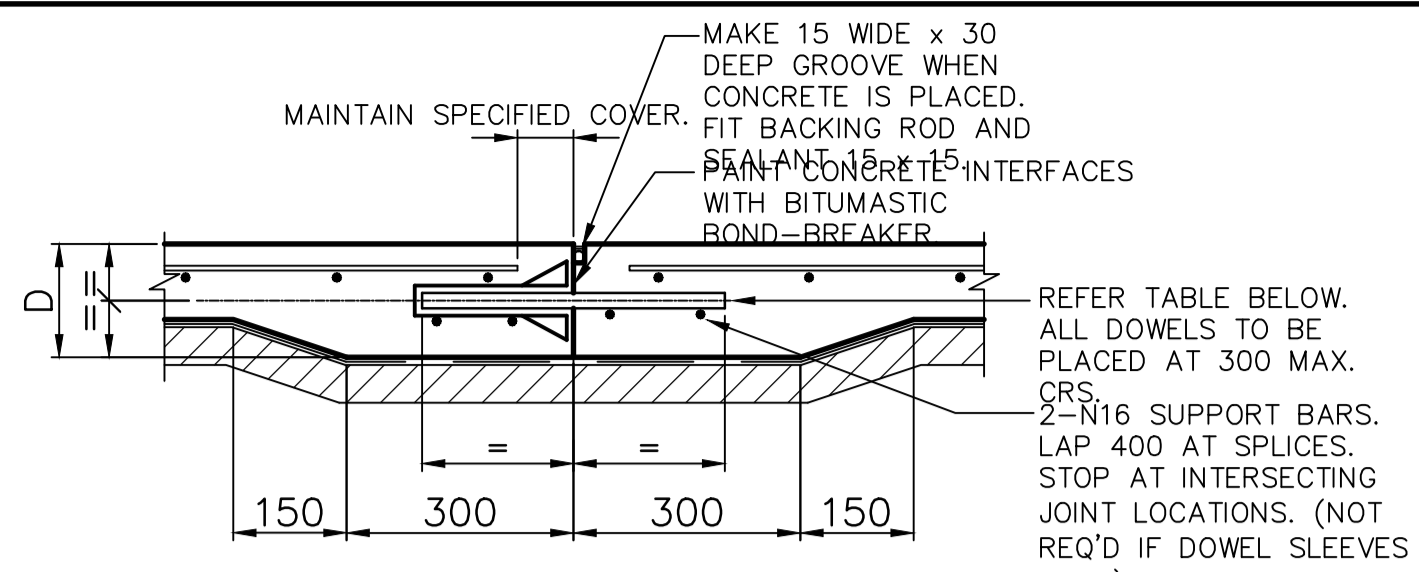

SLAB THICKNESS (mm)	DOWEL SIZE (mm)	DOWEL LENGTH (mm)
125 MIN.	R16	400
126-199	R20	400
200-240	R24	450
241-270	R28	450
271-340	R32	450

DOWELLED CONSTRUCTION JOINT (D.C.J.)
SCALE 1:10

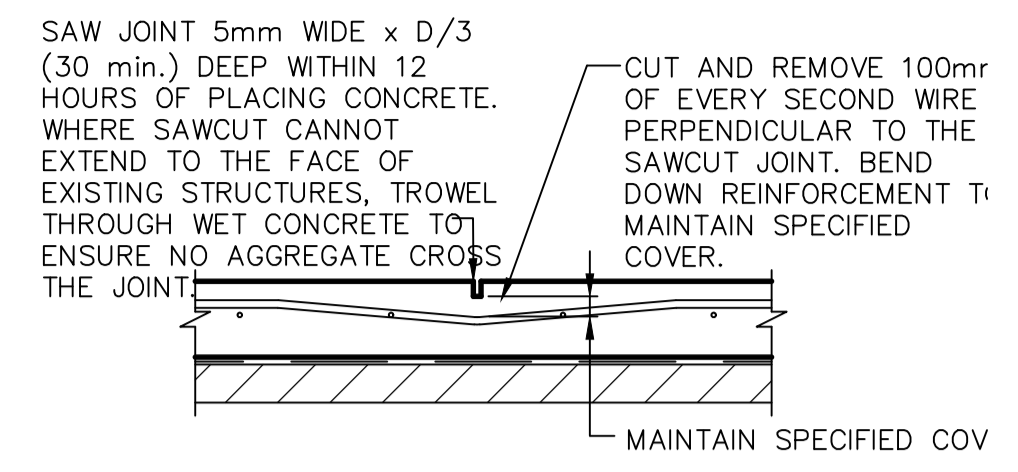

SAWCUT JOINT (S.J.)
SCALE 1:20

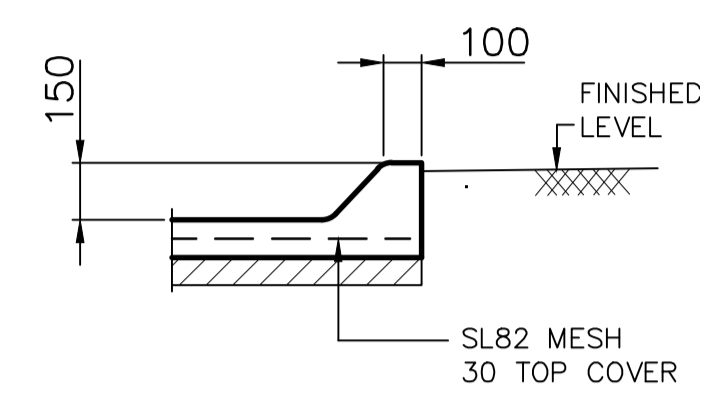

TYPICAL ROLL UP KERB DETAIL

PROVIDE CRACKING CONTROL JOINTS AT 6m MAX. CTRS AND AT MAIN SLA JOINT LOCATIONS

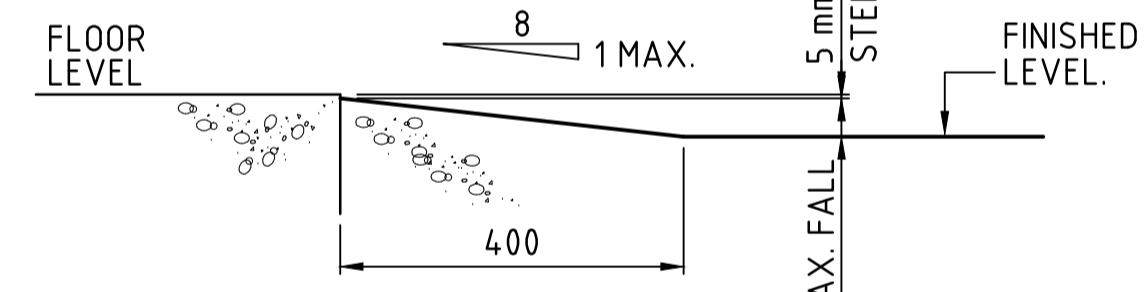
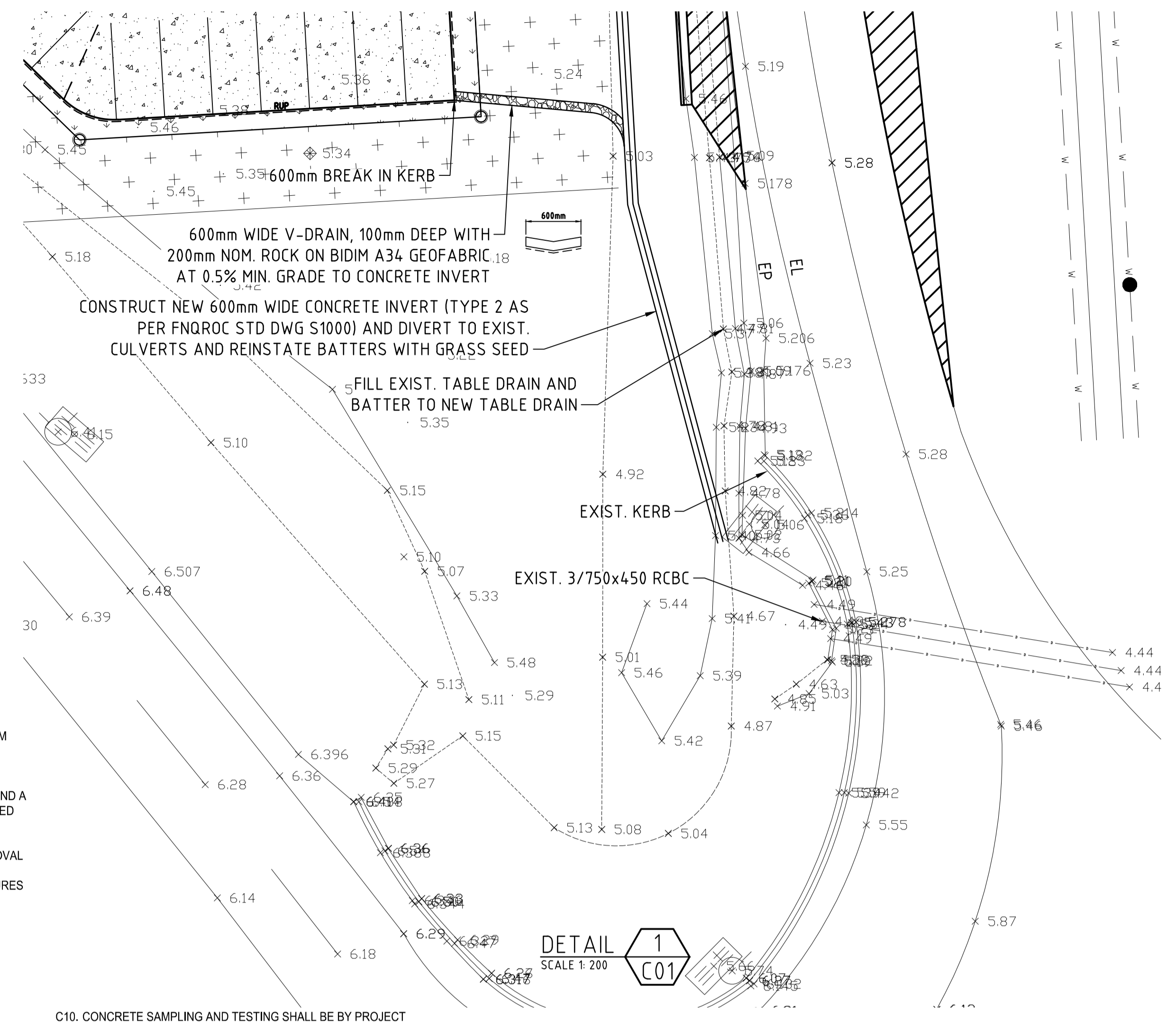

THRESHOLD DETAIL AT FRONT DOOR
SCALE 1:100

NOTES

- THIS SET OF DRAWINGS SHALL BE READ IN CONJUNCTION WITH ALL OTHER CONSULTANTS' DRAWINGS AND SPECIFICATIONS AND WITH OTHER WRITTEN INSTRUCTIONS OR SKETCHES THAT MAY BE ISSUED. ALL DISCREPANCIES SHALL BE REFERRED TO THE SUPERINTENDANT FOR A DECISION BEFORE PROCEEDING WITH THE WORK.
- ALL DIMENSIONS RELEVANT TO SETTING OUT AND OFF-SITE WORK SHALL BE VERIFIED BY THE CONTRACTOR BEFORE CONSTRUCTION AND FABRICATION IS COMMENCED. THE ENGINEERS DRAWINGS SHALL NOT BE SCALED. FOR ALL SETOUT DIMENSIONS REFER TO THE ARCHITECTS OR BUILDING DESIGNERS DRAWINGS.
- THE CONTRACTOR SHALL DETERMINE THE CORRECT LOCATIONS OF ALL EXISTING SERVICES ON SITE PRIOR TO COMMENCEMENT OF WORKS.
- NO SUBSTITUTIONS SHALL BE MADE OR SIZES OF STRUCTURAL MEMBERS VARIED WITHOUT OBTAINING THE APPROVAL OF THE ENGINEER. THE APPROVAL OF A SUBSTITUTION FROM THE ENGINEER SHALL NOT BE AN AUTHORISATION FOR AN EXTRA. ANY EXTRA INVOLVED SHALL BE RESOLVED WITH THE SUPERINTENDANT BEFORE THE WORK COMMENCES.
- ALL MATERIALS AND WORKMANSHIP SHALL BE IN ACCORDANCE WITH THE RELEVANT CURRENT SAA CODES AND THE BY-LAWS, ORDINANCES AND REQUIREMENTS OF THE RELEVANT BUILDING AUTHORITIES EXCEPT WHERE VARIED BY THE PROJECT SPECIFICATION AND CONTRACT DOCUMENTS.
- ALL DIMENSIONS ARE IN MILLIMETRES AND ALL LEVELS ARE IN METRES UNLESS NOTED OTHERWISE.
- DURING CONSTRUCTION THE CONTRACTOR SHALL BE RESPONSIBLE FOR MAINTAINING THE WORKS IN A STABLE CONDITION AND ENSURING NO PART SHALL BE OVERSTRESSED UNDER CONSTRUCTION ACTIVITIES.
- LINEMARKING IS TO BE 100mm WIDE, CONTINUOUS WHITE LINE. ALL PAINT SHALL COMPLY WITH AS. K146 ROAD MARKING PAINT (REFLECTIVE TYPE).
- ALL STORMWATER PIPEWORK IS TO BE UPVC UNLESS NOTED OTHERWISE AND BE IN ACCORDANCE WITH AS 1254.

FOUNDATION & SITE PREPARATION

- SITE EARTHWORKS ARE TO BE CARRIED OUT IN ACCORDANCE WITH "AS3798 GUIDELINES ON EARTHWORKS FOR COMMERCIAL AND RESIDENTIAL DEVELOPMENTS", EXCEPT WHERE VARIED BY THESE NOTES. COMPACTION TESTING AND INSPECTION SHALL BE TYPE 3 AND LEVEL 3. THE CONTRACTOR SHALL PROVIDE TEST CERTIFICATES OF ALL DENSITY TESTS TO THE ENGINEER.
- EXISTING SURFACES UNDER NEW WORKS ARE TO BE STRIPPED OF ALL VEGETATION, TOPSOIL AND UNCONTROLLED FILL. ALL TREE STUMPS AND ROOTS SHALL BE CHASED OUT AND REMOVED. ANY EXCAVATIONS REQUIRED TO REMOVE STUMPS AND ROOTS SHALL BE BACKFILLED WITH COMPACTED FILL. DISTURBED BASES OF EXCAVATIONS SHALL BE COMPACTED TO 98% OF THE STANDARD COMPACTION TEST.
- MOISTURE CONTENT OF EXPOSED SUBGRADE SHALL BE ADJUSTED TO BE ±2% OF OPTIMUM MOISTURE CONTENT.
- THE EXPOSED SURFACE SHALL BE PROOF ROLLED TO ENSURE THAT NO LOCAL SOFT SPOTS EXIST. ANY SOFT SPOTS IDENTIFIED SHALL BE EXCAVATED AND REPLACED WITH COMPACTED FILL.
- FILL, (IF REQUIRED) SHALL BE APPROVED FILL STABLE, FREE FROM ORGANIC MATTER. HAVE A LINEAR SHRINKAGE NOT GREATER THAN 12%, A PLASTICITY INDEX NOT GREATER THAN 20, A MAXIMUM NOMINAL SIZE OF 75MM AND A MINIMUM SOAKED CBR OF 15.
- FILL MATERIAL IS TO BE PLACED IN LAYERS NOT EXCEEDING 300mm LOOSE THICKNESS AND COMPACTED TO 98% OF THE STANDARD COMPACTION TEST.
- THE CONTRACTOR SHALL ENSURE THAT THE SIDES AND BOTTOMS OF ALL EXCAVATIONS ARE STABLE DURING ALL STAGES OF CONSTRUCTION AND REMAIN FREE OF ORGANIC MATERIAL AND RUBBISH.
- THE SLAB AND FOUNDATION DESIGN HAS BEEN BASED ON THE FOLLOWING ASSUMPTIONS. MINIMUM SOAKED CBR OF SUB BASE = 5%
SHOULD CONDITIONS OTHER THAN THOSE ABOVE BE ENCOUNTERED THEN REFER TO THE ENGINEER FOR POSSIBLE REDESIGN.

CONCRETE

- ALL CONCRETE MATERIALS AND WORKMANSHIP SHALL COMPLY WITH AS3600 EXCEPT WHERE VARIED BY THE CONTRACT DOCUMENTS.
- PROPERLY FORM ALL CONSTRUCTION JOINTS AND LOCATE THEM ONLY WHERE SHOWN OR SPECIFICALLY APPROVED BY THE STRUCTURAL ENGINEER.
- ALL CONCRETE SUPPLIED SHALL HAVE A SLUMP OF 80+/-15mm AND A MAXIMUM NOMINAL AGGREGATE SIZE OF 20mm UNLESS SPECIFIED OTHERWISE.
- NO ADMIXTURES SHALL BE USED WITHOUT THE WRITTEN APPROVAL OF THE STRUCTURAL ENGINEER EXCEPT IN STANDARD CONTROLLED GRADE CONCRETE. CALCIUM CHLORIDE ADMIXTURES WILL NOT BE PERMITTED UNDER ANY CIRCUMSTANCES.
- REINFORCEMENT SYMBOLS
R - GRADE 230R PLAIN ROUND BARS TO AS4671
N - GRADE 500 DEFORMED BARS TO AS4671
L - GRADE 500 HARD DRAWN WELDED WIRE FABRIC TO AS4671
W - HARD DRAWN PLAIN WIRE TO AS4671
- THE MINIMUM FABRIC LAP SHALL BE TWO CROSS WIRES PLUS 25mm. STAGGER SHEETS TO AVOID EXCESSIVE THICKNESS AT LAPS.
- DO NOT WELD REINFORCEMENT WITHOUT THE APPROVAL OF THE STRUCTURAL ENGINEER.
- PROVIDE 3-N12 DIAGONAL BARS x 2000 LONG IN THE TOP LAYER AT ALL RE-ENTRANT CORNERS. 100 MIN. SPACING.
- SUPPORT ALL REINFORCEMENT SECURELY IN ITS CORRECT POSITION DURING CONCRETING BY SECURELY TYING WITH 1.25mm WIRE TO APPROVED PLASTIC TIPPED BAR CHAIRS, SPACERS OR SUPPORT BARS. SUPPORT SPACINGS SHALL BE SUCH AS TO POSITION AND MAINTAIN THE REINFORCEMENT TO THE TOLERANCES OF AS3600 AND SHALL BE AT 800mm MAXIMUM CENTRES IN SLABS. PLASTIC TIPPED STEEL BAR CHAIRS SHALL NOT BE USED FOR EXTERNAL WORK.

- CONCRETE SAMPLING AND TESTING SHALL BE BY PROJECT ASSESSMENT TO AS3600 AND AS1379 UNLESS SPECIFIED OTHERWISE
- COMPACT ALL CONCRETE DURING PLACEMENT USING MECHANICAL VIBRATORS.
- CURE ALL CONCRETE SURFACES EXPOSED WITHIN 7 DAYS OF INITIAL SET USING A METHOD APPROVED BY AS3798 OR THE STRUCTURAL ENGINEER. COMMENCE CURING WITHIN 1 HOUR OF INITIAL SET OR FIRST EXPOSURE. AND CONTINUE FOR AT LEAST 7 DAYS AFTER POURING CONCRETE.
- THE PROCEDURES OUTLINED IN TECHNICAL BULLETIN 95/1 BY THE AUSTRALIAN PREMIXED CONCRETE ASSOCIATION SHALL BE FOLLOWED TO REDUCE THE RISK OF PLASTIC SHRINKAGE CRACKING.
- ALL FORMWORK MATERIALS AND WORKMANSHIP SHALL COMPLY WITH AS3610 AND AS3600.
- FORMWORK STRIPPING SHALL BE IN ACCORDANCE WITH AS3610 UNLESS SPECIFIED OR APPROVED OTHERWISE.

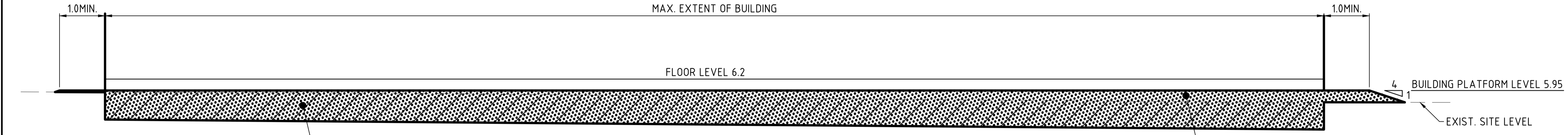

SECTION B
SCALE 1:50

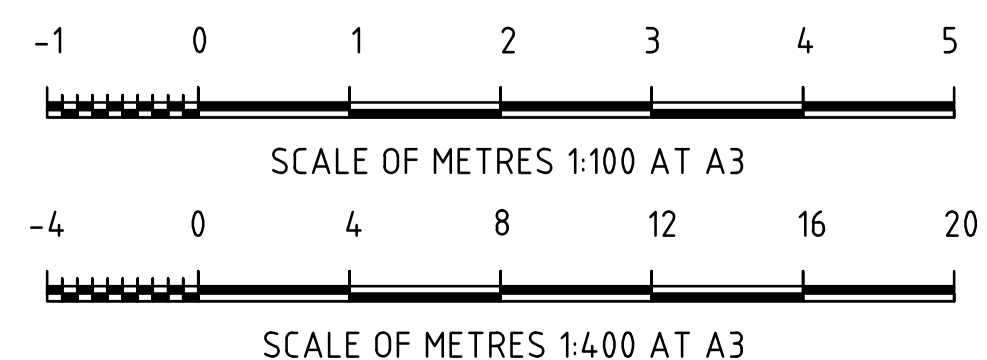
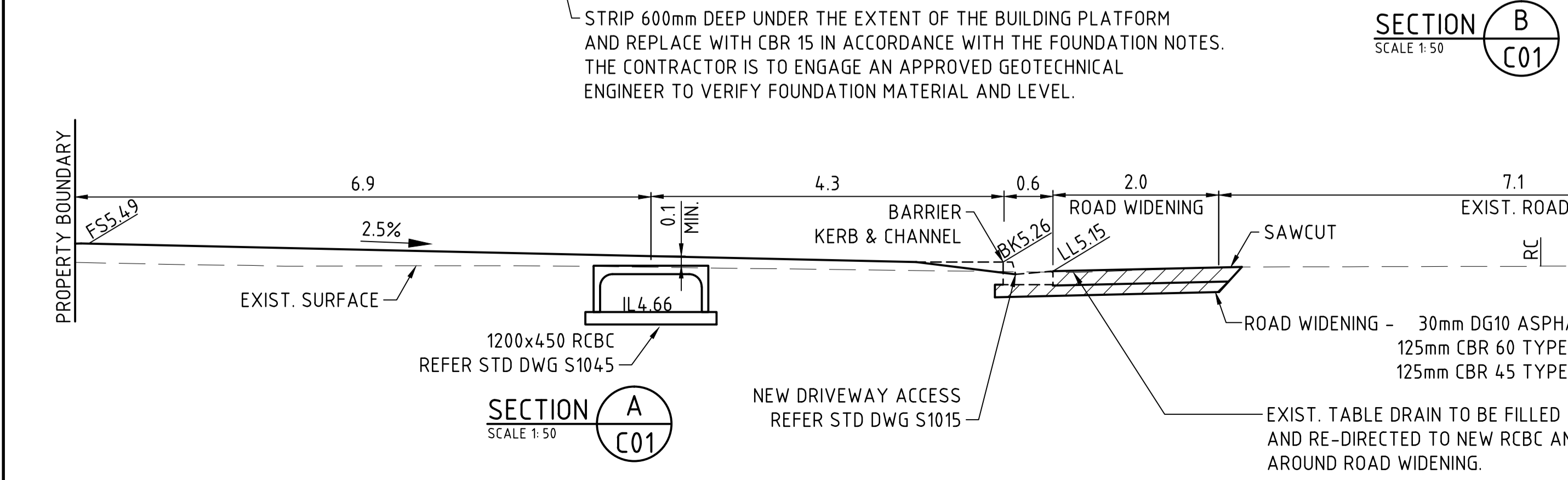

N

REVISION	APPD	DATE
F FOR APPROVAL		
E MINOR AMENDMENTS	DEJ	25/06/12
D STORMWATER AMENDED	DEJ	07/06/12
C SECTION "A" REVISED	PAV	16.04.12
B INFO REQ 21/5/2008	LCJ	17.06.08
A ORIGINAL ISSUE	LCJ	09.10.07

FOR APPROVAL

© COPYRIGHT
THIS DOCUMENT IS AND SHALL REMAIN THE PROPERTY OF LCJ ENGINEERS PTY LTD. THE DOCUMENT MAY ONLY BE USED FOR THE PURPOSE FOR WHICH IT WAS COMMISSIONED AND IN ACCORDANCE WITH THE TERMS OF ENGAGEMENT FOR THE COMMISSION. UNAUTHORISED USE OF THIS DOCUMENT IN ANY WAY IS PROHIBITED.

LCJ ENGINEERS

LCJ Engineers Pty Ltd
ABN 66 196 373 875
601 Flinders Street PO Box 1498
Townsville QLD 4810 Aitkenvale QLD 4814
T 07 4721 5800 F 07 4721 5900
townsville@lcjengineers.com.au
www.lcjengineers.com.au

CAD FILE NAMES	
DRAWN	DESIGNED
OFC	PWE
APPROVED	DATE
L.C. JOHNSTONE	09.10.07

CLIENT
TAYLOR HOMES

PROJECT
PORT DOUGLAS CHILDCARE CENTRE

LOT 2 ON C2256 - CNR CAPTAIN COOK HIGHWAY AND DAVIDSON ST

DRAWING
SECTIONS AND DETAILS

NUMBER	SHEET NO.	REVISION
TAY14101	C03	F

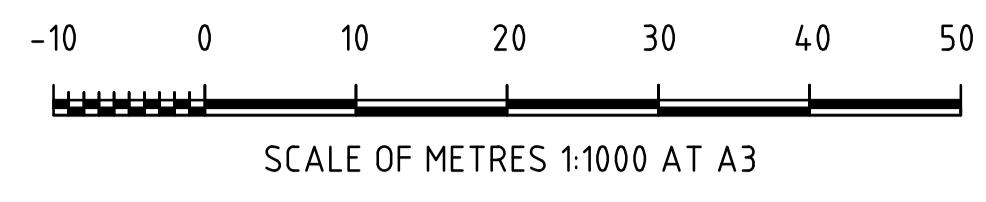
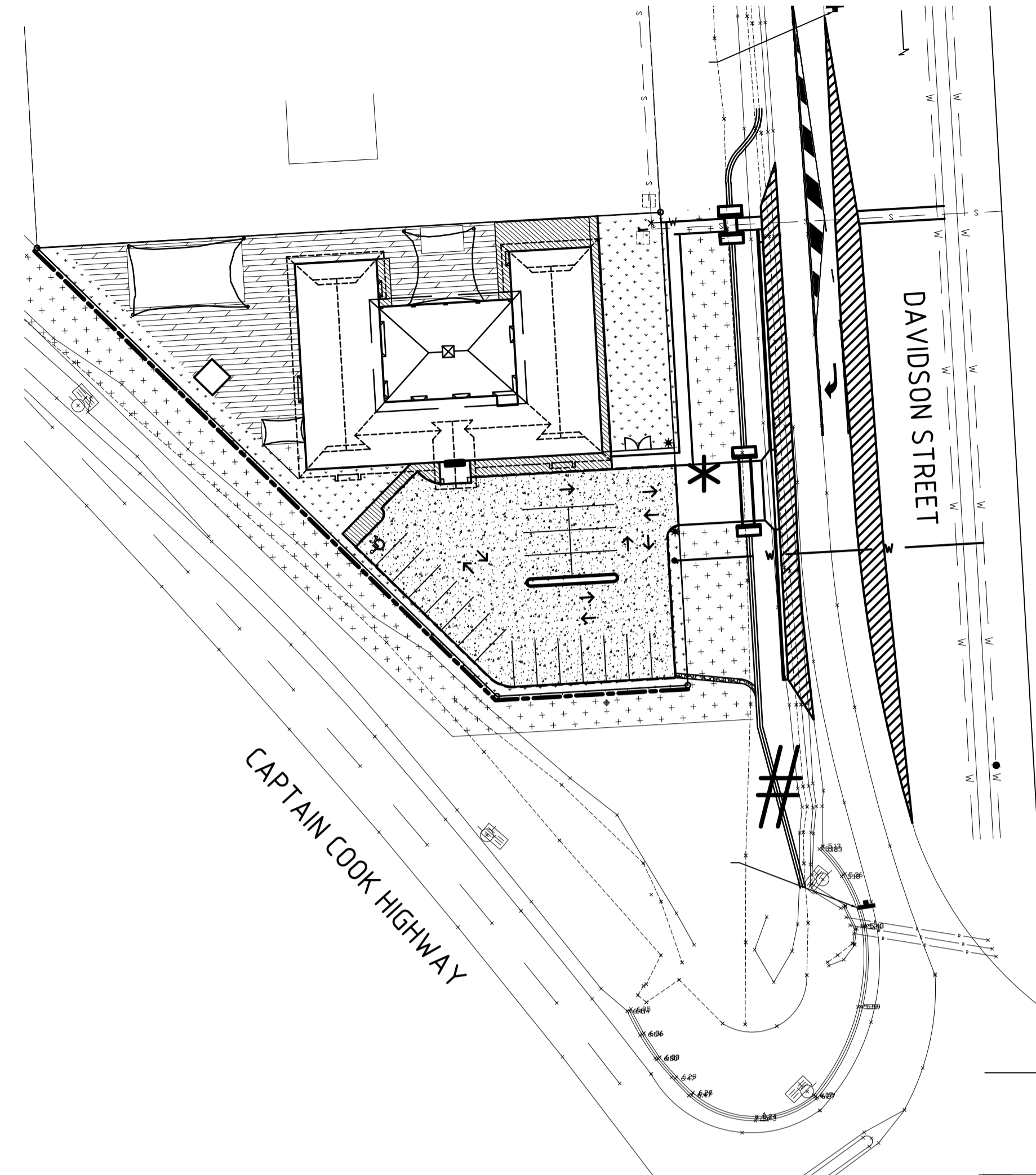

LEGEND

--- SEDIMENT FENCE

* TEMPORARY CONSTRUCTION ENTRY / EXIT

TEMPORARY SEDIMENT BASIN WITH ROCK CHECK DAM

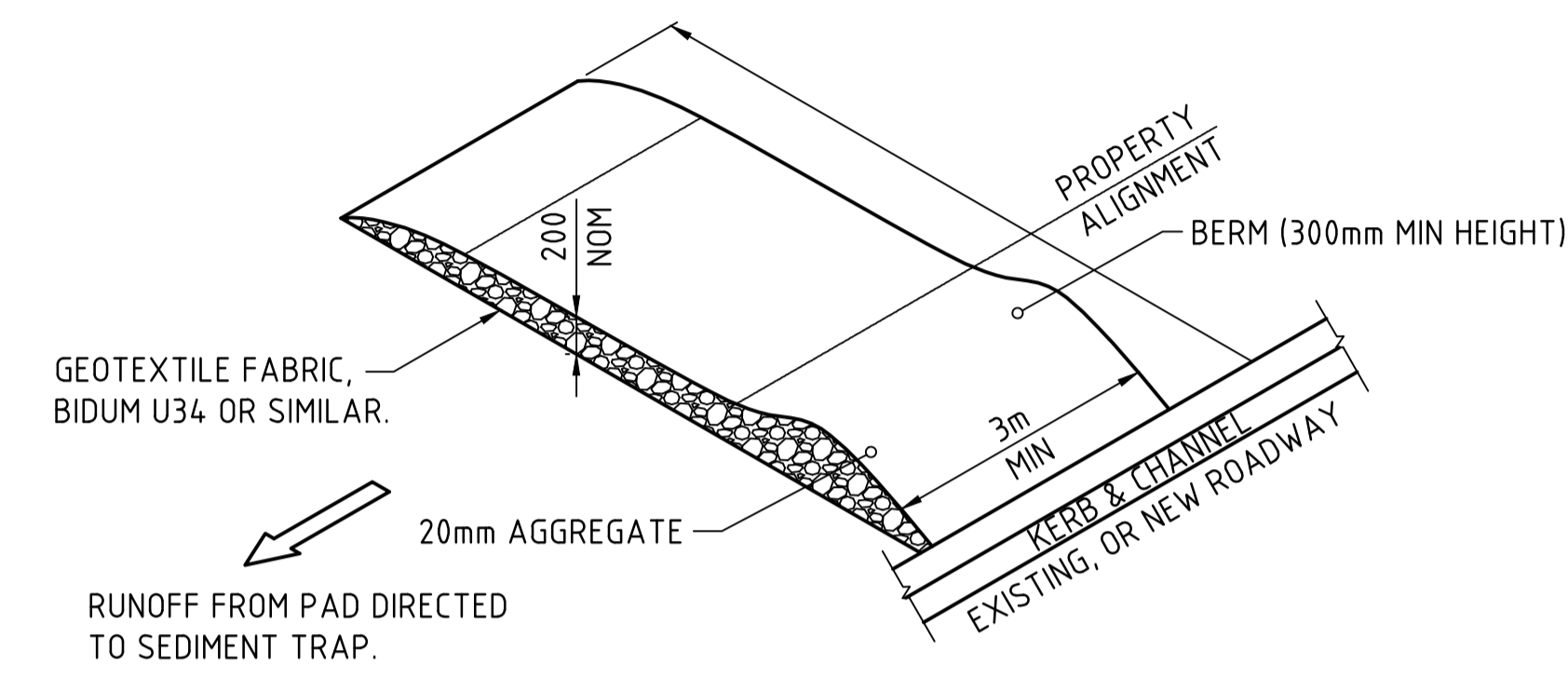

TEMPORARY CONSTRUCTION ENTRY / EXIT

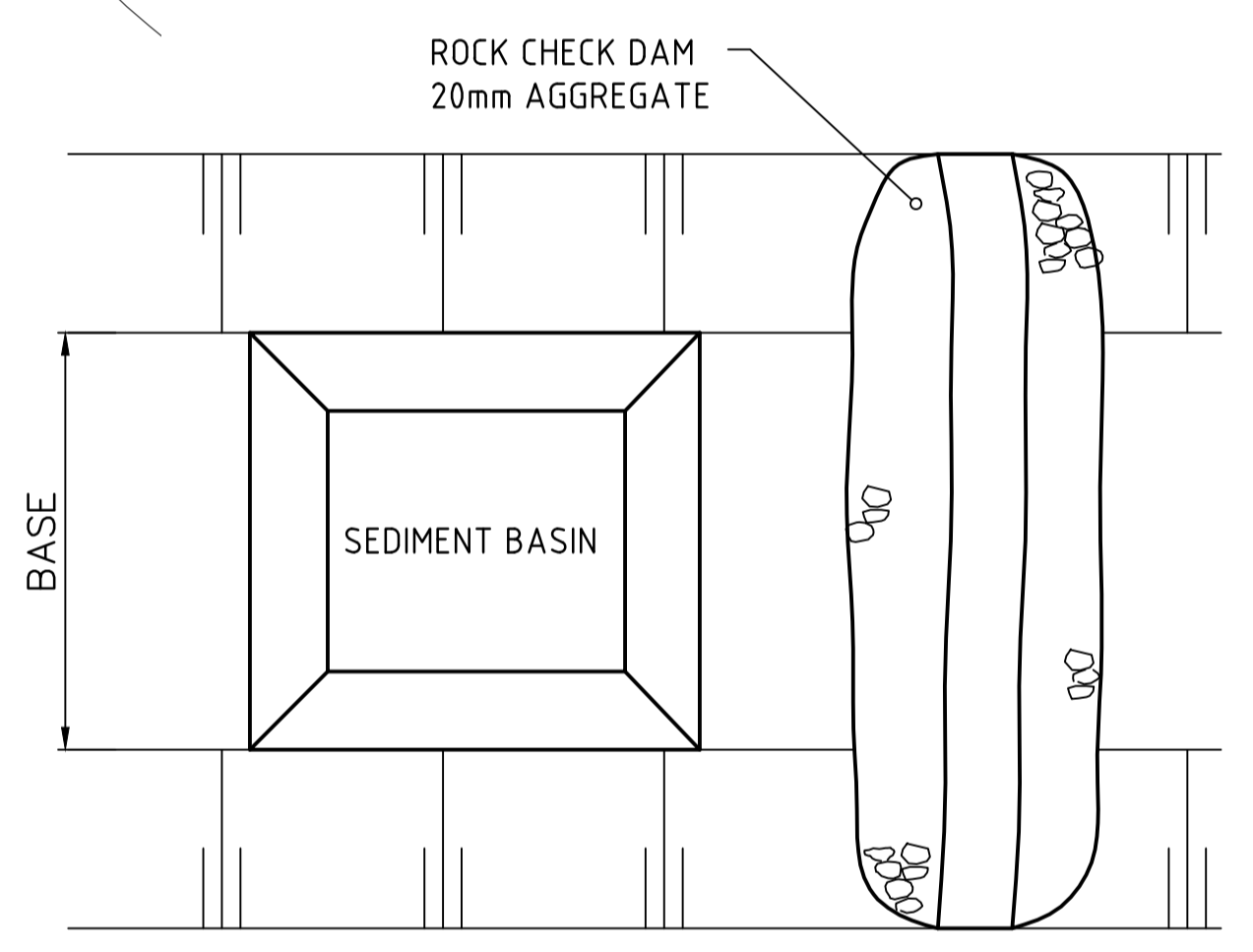

PLAN

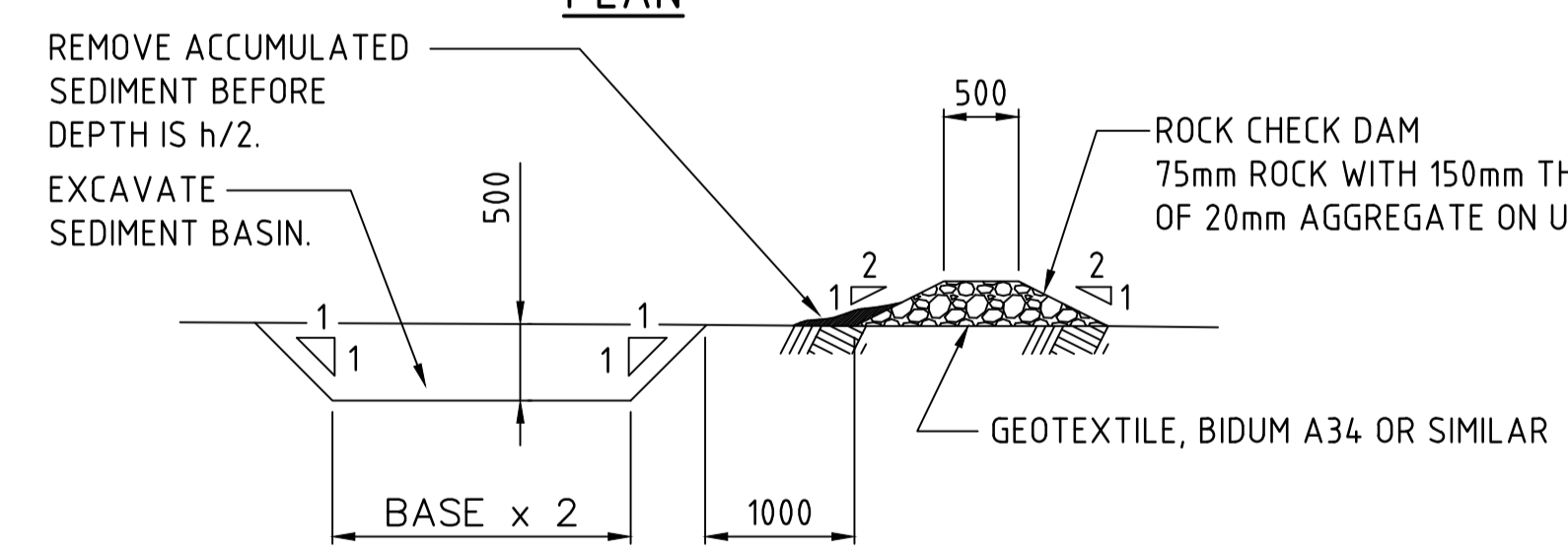

ELEVATION
"A" TO BE HIGHER THAN "B" TO PREVENT SEDIMENT BYPASS.

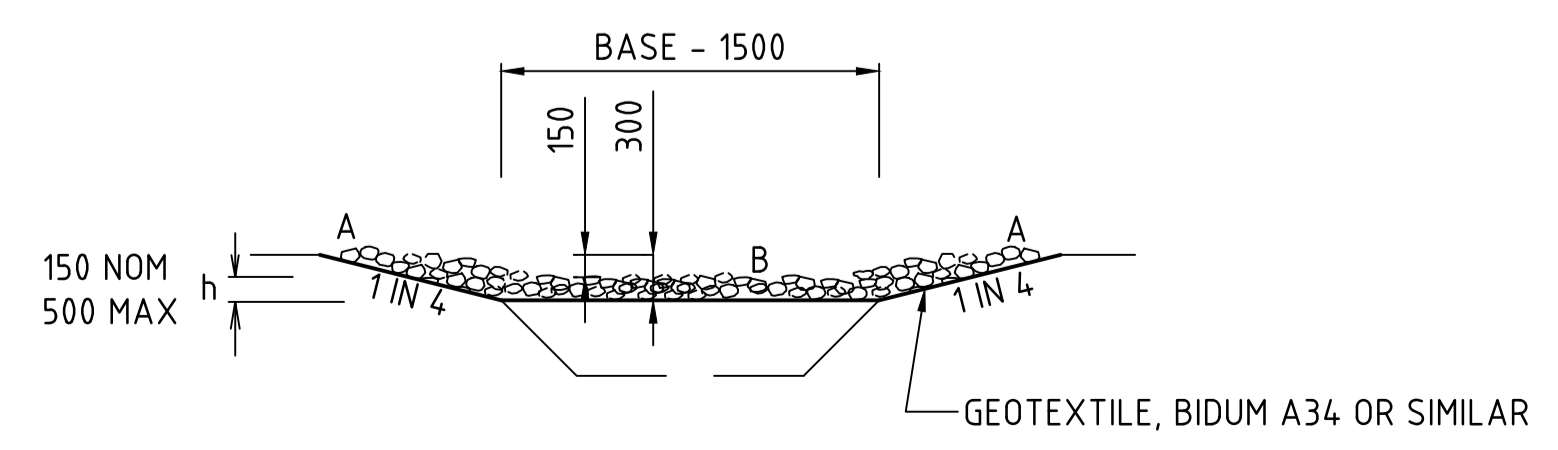

SECTION

SEDIMENT BASIN WITH ROCK CHECK DAM

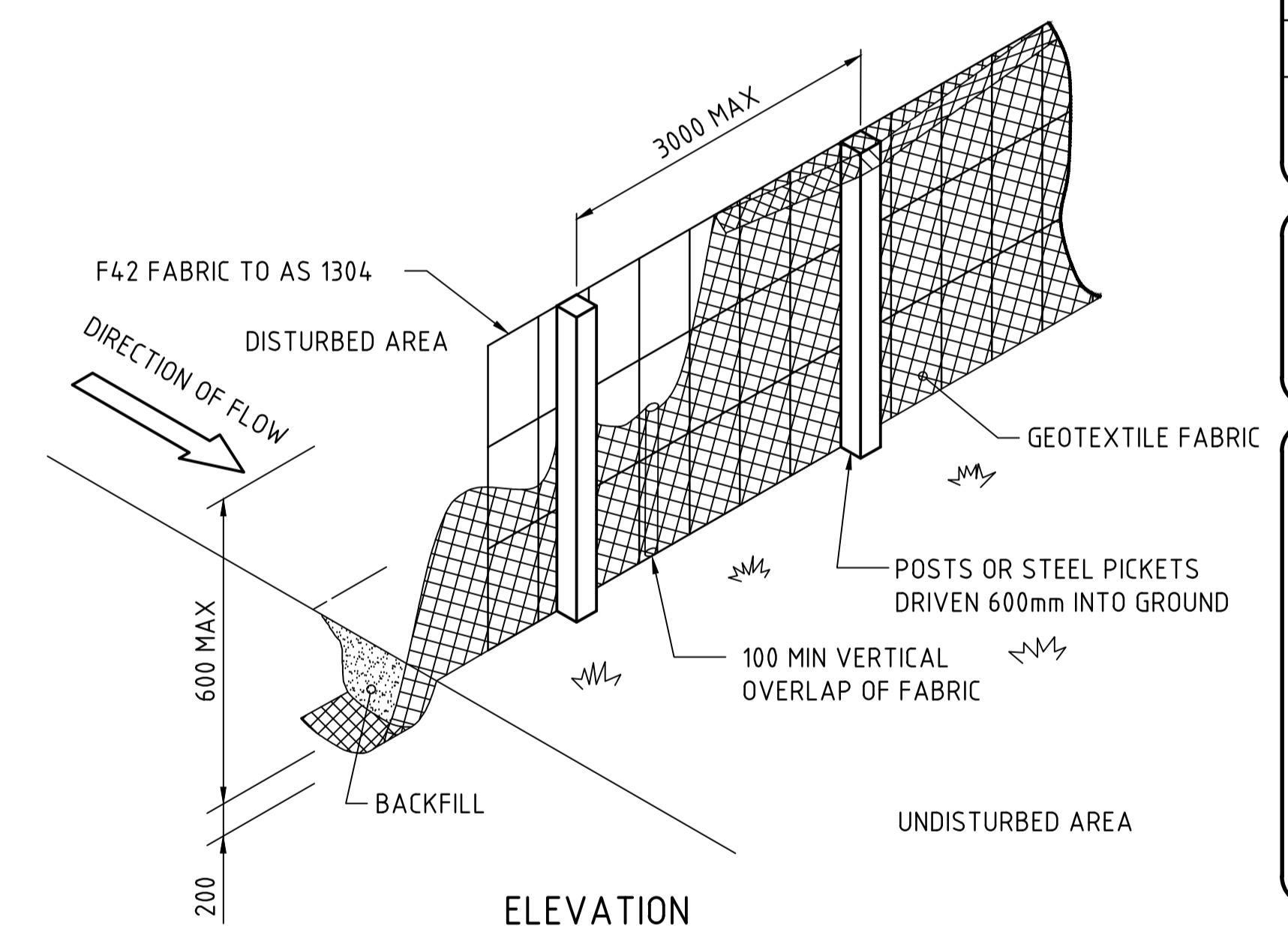

ELEVATION

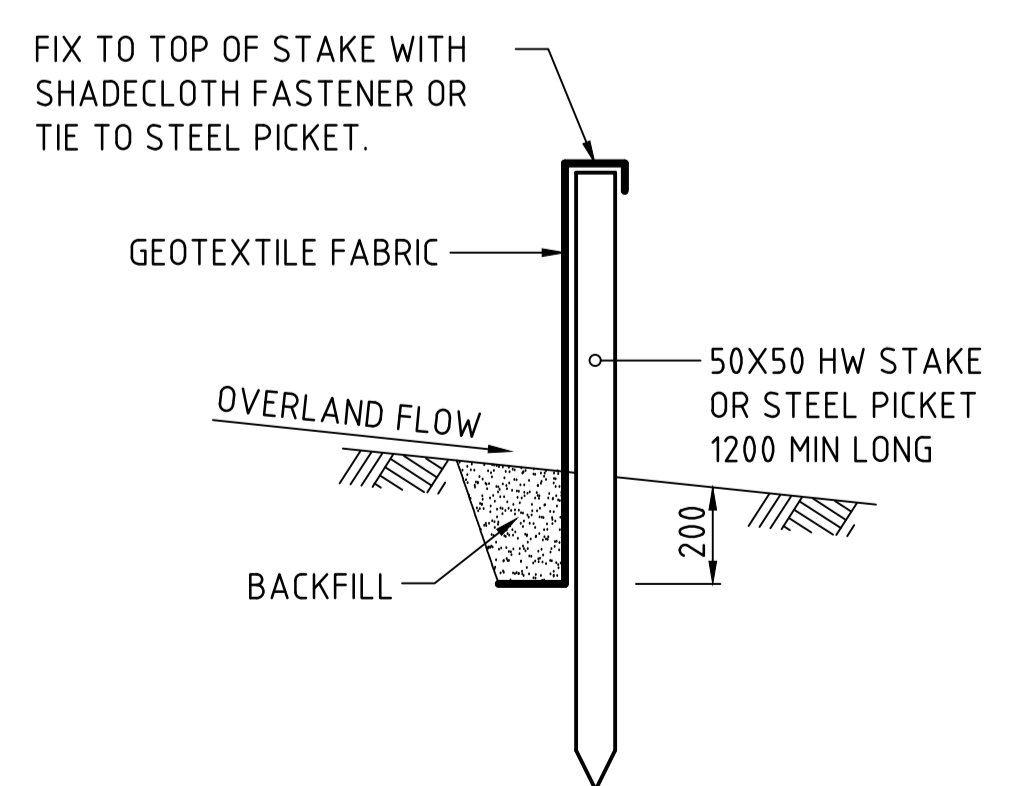

ALTERNATIVE 1

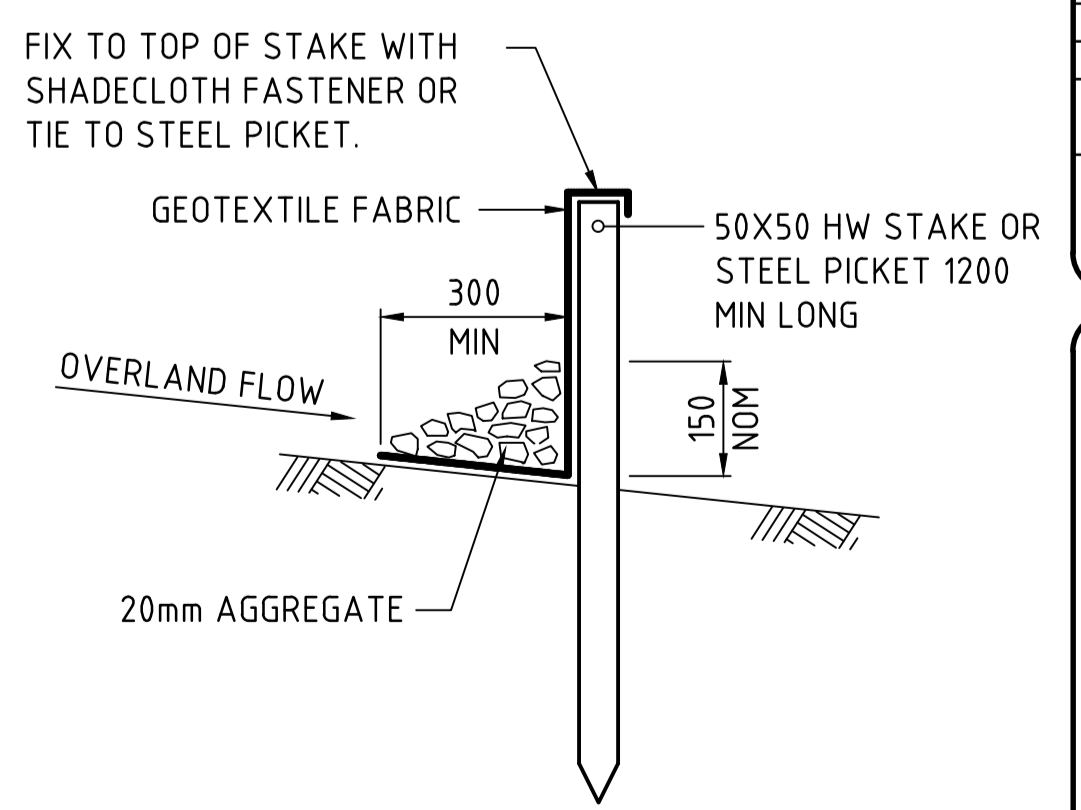

ALTERNATIVE 2

SEDIMENT FENCE

NOTES

1. General
 - a. Temporary drainage control. Flow should be diverted around the work site where possible.
 - b. All drainage, erosion and sediment controls to be installed and be operational before commencing up-slope earthworks.
 - c. All control measures to be inspected at least weekly and after significant runoff producing storms.
 - d. Straw bale sediment traps are a secondary option which generally should not be used if other options are available.
 - e. No parking or stockpiling of materials is permitted on the lower side of the sediment fence.
 - f. Grass verges shall be maintained as much as practical to provide a buffer zone to the construction site.
 - g. Roof drainage is to be connected to the stormwater as soon as practical.
 - h. Builder shall ensure all construction traffic entering and leaving the site do so in a forward direction.
 - i. Safety issues must be considered at all times & incorporate traffic control devices to the satisfaction of the Superintendent.
 - j. Control measures may be removed when on-site erosion is controlled and 70% permanent soil coverage is obtained over all upstream disturbed land.
 - k. In areas where runoff turbidity is to be controlled, exposed surfaces to be either mulched, covered with erosion control blankets or turfed if earthworks are expected to be delayed for more than 14 days.
2. Sediment Fence
 - a. Not to be located in areas of concentrated flow.
 - b. Normally located along the contour with a maximum catchment area 0.6 ha per 100m length of fence.
 - c. Woven fabrics are preferred, non-woven fabrics may be used on small work sites, i.e. operational period less than 6 months or on sites where significant sediment runoff is not expected.
 - d. Fences are required 2m MIN from toe of cut or fill batters, where not practical one fence can be at the toe with a second fence 1m MIN away. Fence should not be located parallel with toe if concentration of flow will occur behind the fence.
 - e. Where fences need to be located across the contour the layout shall conform to 'Typical Layout Across Grade'.
3. Temp Construction Entry/Exit Sediment Trap.
 - a. Adjacent stormwater runoff to be diverted away from entry/exit.
 - b. Wheel - wash or spray unit may be required during wet weather.
 - c. Alternative of temporary cattle grid to be considered if approved by Council Engineer.
4. Check Dams
 - a. Catchment area limited to 4 ha.
 - b. Use in minor open drains only, (velocity control), sediment collection is a secondary purpose.

REVISION	APP'D	DATE
D FOR APPROVAL		
C PATHWAYS & CULVERT AMENDED	PAV	16.04.12
B INFO REQ 21/5/2008	LCJ	17.06.08
A ORIGINAL ISSUE	LCJ	09.10.07

FOR APPROVAL

© COPYRIGHT
THIS DOCUMENT IS AND SHALL REMAIN THE PROPERTY OF LCJ ENGINEERS PTY LTD. THE DOCUMENT MAY ONLY BE USED FOR THE PURPOSE FOR WHICH IT WAS COMMISSIONED AND IN ACCORDANCE WITH THE TERMS OF ENGAGEMENT FOR THE COMMISSION. UNAUTHORISED USE OF THIS DOCUMENT IN ANY WAY IS PROHIBITED.

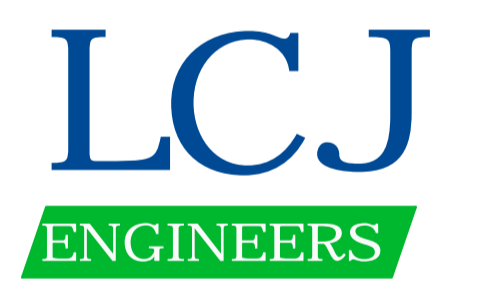

LCJ Engineers Pty Ltd
 ABN 66 196 373 875
 601 Flinders Street PO Box 1498
 Townsville QLD 4810 Aitkenvale QLD 4814
 T 07 4721 5800 F 07 4721 5900
 townsville@lcjengineers.com.au
 www.lcjengineers.com.au

CAD FILE NAMES	
DRAWN	DESIGNED
OFC	LCJ
APPROVED	DATE
L.C. JOHNSTONE	09.10.07

CLIENT	TAYLOR HOMES
PROJECT	PORT DOUGLAS CHILDCARE CENTRE
LOT 2 ON C225 6 - CNR CAPTAIN COOK HIGHWAY AND DAVIDSON ST	
DRAWING	SOIL EROSION & SEDIMENT CONTROL PLAN
NUMBER	SHEET NO. / REVISION
TAY14101	C04 / D