

24 November 2023

Enquiries: Rebecca Taranto
Our Ref: EXEM 2023_5552/1 (Doc:1198425)
Your Ref: 232509/01

Administration Office
64 - 66 Front St Mossman
P 07 4099 9444
F 07 4098 2902

C D Ramsey & K J Ramsey
46 Endeavour Street
PORT DOUGLAS QLD 4877

Dear Sir / Madam

EXEMPTION CERTIFICATE

Council refers to your request for an exemption certificate for the following premises received on 21/11/2023.

Summary of Exempt Development

Construction of a gazebo with the Flood and Storm Tide Hazard overlay.

Location details

Street Address: 46 Endeavour Street PORT DOUGLAS

Real Property Description: Lot 154 on RP747297

Local Government Area: Douglas Shire Council

Decision

Council advises that an exemption certificate has been granted on 24 November 2023 for development as detailed in Attachment 1.

Referral agencies

Not Applicable

Reasons for giving exemption certificate

The development is exempt under this certificate under s46(3)(b) of the *Planning Act 2016* for the following reason(s):

- The effects of the development would be minor or inconsequential, considering the circumstances under which the development was categorised as assessable development.

When exemption certificate ceases to have effect

This exemption certificate does not lapse.

Other

Please quote Council's application number: EXEM 2023_ 5552/1 in all subsequent correspondence relating to this request.

Should you require any clarification regarding this matter, please contact Rebecca Taranto on telephone 07 4099 9444.

Yours faithfully



For
Paul Hoyer
Manager Environment & Planning

cc Emailed to Patio World – karina@patioworld.com.au

Attachment 1

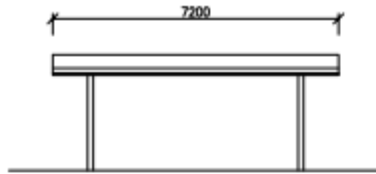

ELEVATION A
1:100

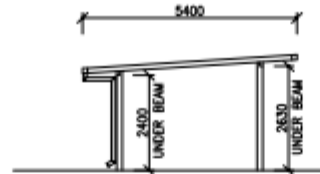

ELEVATION B
1:100

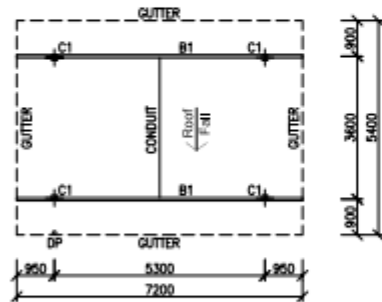

PLAN VIEW
1:100

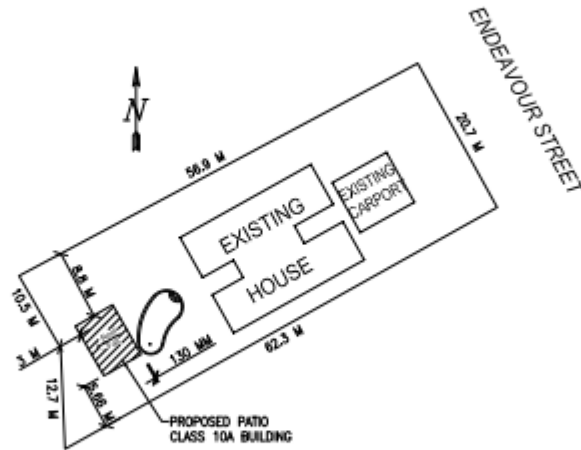

SITE PLAN
1:500

IMPORTANT!
METAL STRUCTURES WITHIN 1250 MM OF THE INSIDE EDGE OF A POOL ARE REQUIRED TO BE BONDED TO EARTH - REFER AS/NZS 3000:2018. THIS MAY ONLY BE CARRIED OUT BY A SUITABLY LICENSED ELECTRICIAN AND THEREFORE DOES NOT FORM PART OF WORKS ORGANISED AND/OR CARRIED OUT BY PATIO WORLD.

APOLLO ROOF - 38.9 SQ. M. COVER.
16 SHEETS @ 5325 MM.

B1: 170x75 APOLLO BEAM
REFER APOLLO MANUAL PG.47

C1: 140x140x3 AL. POST.
POST LOAD: 15.2KN.
CONCRETE FOOTING: #450x1300 MM

ELECTRICAL: ONE CONDUIT.

GENERAL NOTE:

ALL MEMBERS AND FIXINGS PROTECTED AGAINST CORROSION I.E. GALVANISED, COATED OR WRAPPED IN PLASTIC MEMBRANE IF CAST INTO CONCRETE UNLESS OTHERWISE SPECIFIED.

ALL SUPPORT BEAMS WITH SPANS OF 6 METRES OR GREATER SHALL BE PROPPED UP IN THE CENTRE OF BEAM SPAN TO CREATE A MINIMUM OF A 10 MM CAMBER OR MORE. ANY BEAM DEFLECTION CAUSING GUTTER TO HOLD WATER SHOULD BE COMPENSATED FOR WITH FALL ON BEAM AND GUTTER TOWARDS DOWN PIPE.

APOLLO BEAMS TO BE STITCHED @ 200 CRS OFFSET WITH 10-16x16 WAFER HEAD TEK SCREWS.

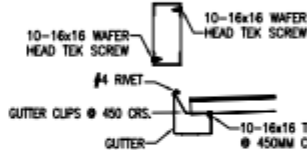

BACK CHANNEL AS SIDE BARGE (IF APPLICABLE) FIXED TO ROOF SHEET @ 500 CRS. WITH 10-16x16 WAFER HEAD TEK SCREWS.

FIX END CAP TO BEAM END WITH 2/10-16x16 WAFER HEAD TEK SCREWS EACH SIDE.

SHEETING, BEAMS AND FIXINGS IN ACCORDANCE WITH AS1170.2 & LOW-HIGH-LOW (LHL) REGIMEN TESTED MARCH 2008 - REPORT TS689.

TERMITE RISK MANAGEMENT:
WHERE TERMITE SUSCEPTIBLE BUILDING ELEMENTS ARE USED OR EXISTING TERMITE BARRIERS ARE BREACHED NEW TERMITE BARRIER SYSTEM MUST BE INSTALLED IN ACCORDANCE WITH AS3660.

STORM WATER IN ACCORDANCE WITH AS3500.3.

EXISTING FOOTINGS AND TIE-DOWN CONNECTIONS TO BE ASSESSED AND UPGRADED IF DEEMED INADEQUATE.

WARNING:
DO NOT WALK DIRECTLY ON ROOFING SHEETS. USE A TEMPORARY WALKWAY FOR MAINTENANCE ACCESS. USE A 250x38 MM PLANK BETWEEN ANY TWO ROOF PANEL SUPPORT MEMBERS. DO NOT LOCATE PLANK MORE THAN 1 METRE FROM A SUPPORT MEMBER.

IMPORTANT:
THESE PLANS SHOW INTENDED DESIGN ONLY AND ARE BY NO MEANS AN INSTRUCTION MANUAL. CONSTRUCTION MUST BE CARRIED OUT BY PERSONS WITH KNOWLEDGE OF CURRENT BUILDING REGULATIONS/ PRACTICES AND RELEVANT ENGINEERING MANUALS REFERRED TO ON THESE PLANS.

ALL MEASUREMENTS AND SPECIFICATIONS MUST BE CHECKED PRIOR TO COMMENCEMENT OF CONSTRUCTION.

ANY EXISTING STRUCTURES PROVIDING SUPPORT ARE TO BE ASSESSED AS ADEQUATE OR SUPPLEMENTED AS REQUIRED FOR ADDITIONAL LOADS APPLIED. STABILITY OF BUILDING DURING CONSTRUCTION (INCLUDING ADDITIONAL PROPPING, BRACING AND EXCAVATION) IS THE RESPONSIBILITY OF THE PERSON(S) CARRYING OUT CONSTRUCTION.



QBCC No: 56714

© COPYRIGHT 2023 Patio World

Patio World Head Office:
30 Cannon St
Cairns, Qld 4870
Ph (07) 40321166

SCALE AT A3: 1:100
(unless otherwise shown)

CONSULTANT: GL

DRAWN BY: CR

SHEET: 1 of 2

**PROPOSED PATIO FOR
CHRIS & KRISTIN RAMSEY
46 ENDEAVOUR STREET
PORT DOUGLAS QLD 4879**

DESIGN WIND SPEED: C2

LOT No. 154 DATE: 16-11-2023 JOB NO. REV.

PLAN NO: RP747297 REV. DATE: 15461 -

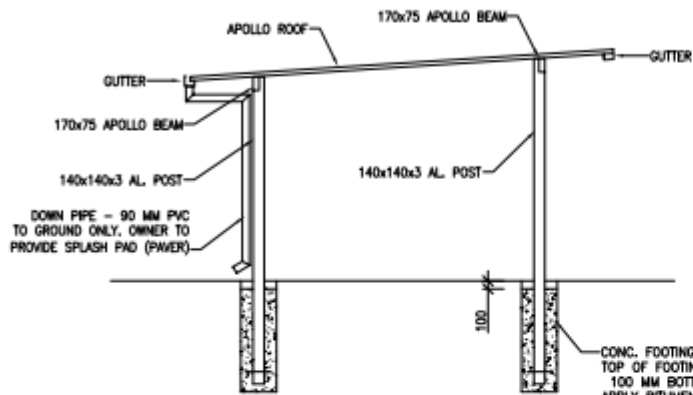

TYPICAL SECTION
1:50

CONC. FOOTING: #450x1300 MM
TOP OF FOOTING 100 MM BELOW GROUND.
100 MM BOTTOM COVER. 16 MM BAR THRU POST.
APPLY BITUMEN PAINT - ORMONOID OR SIMILAR TO
CAST-IN LENGTH + 50 MM ABOVE FINISHED SURFACE.
OWNER TO PAINT OVER WITH SUITABLE PRODUCT
ACCORDING TO MANUFACTURER'S SPECIFICATIONS.

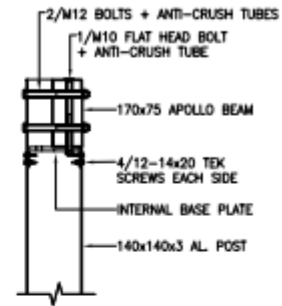

C1: POST TO BEAM DETAIL
NTS

APOLLO ROOF PANEL
0.42 0550 FIXED WITH 12-24x30 TEK
SCREWS WITH NEO. CYCLONE WASHERS



ROOF FIXING DETAIL
NTS

 PATIO WORLD QBCC No: 56714 © COPYRIGHT 2023 Patio World	Patio World Head Office: 39 Cannon St, Cairns, Qld 4870 Ph (07) 40321166		PROPOSED PATIO FOR CHRIS & KRISTIN RAMSEY 46 ENDEAVOUR STREET PORT DOUGLAS QLD 4879		
	SCALE AT A3: 1:100 (unless otherwise shown)		DESIGN WIND SPEED: C2		
CONSULTANT: GL	DRAWN BY: CR	LOT No. 154	DATE: 16-11-2023	JOB NO.:	REV.
SHEET: 2 of 2	PLAN NO: RP747297	REV. DATE: -	15461	-	-