

28 August 2025

Enquiries: Daniel Lamond
Our Ref: EXEM 2025_5821/1 (1317982)
Your Ref: 35437

Administration Office
64 - 66 Front St Mossman
P 07 4099 9444
F 07 4098 2902

J & V Noli Pty Ltd
PO Box 74
MOSSMAN QLD 4873

Dear Sir / Madam

EXEMPTION CERTIFICATE

Council refers to your request for an exemption certificate for the following premises received on 12 August 2025.

Summary of Exempt Development

Development being made exempt from the 2018 Douglas Shire Planning Scheme Flood and Storm Tide Hazard Overlay Code consists of the processing shed as detailed in Attachment 1.

Location details

Street Address: 6868 Captain Cook Highway KILLALOE

Real Property Description: LOT: 32 SP: 332240

Local Government Area: Douglas Shire Council

Decision

Council advises that an exemption certificate has been granted on 28 August 2025 for development as detailed in Attachment 1.

Referral agencies

Not Applicable

Reasons for giving exemption certificate

The development is exempt under this certificate under s46(3)(b) of the *Planning Act 2016* for the following reason(s):

- The effects of the development would be minor or inconsequential, considering the circumstances under which the development was categorised as assessable development.

When exemption certificate ceases to have effect

This exemption certificate does not lapse.

Other

Please quote Council's application number: EXEM 2025_ 5821/1 in all subsequent correspondence relating to this request.

Should you require any clarification regarding this matter, please contact Daniel Lamond on telephone 07 4099 9444.

Yours faithfully



For
Leonard Vogel
Manager Environment & Planning

cc Emailed to Brazier Motti Pty Ltd – cairns@braziermotti.com.au

Attachment 1

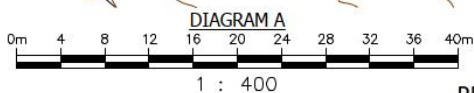
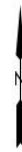
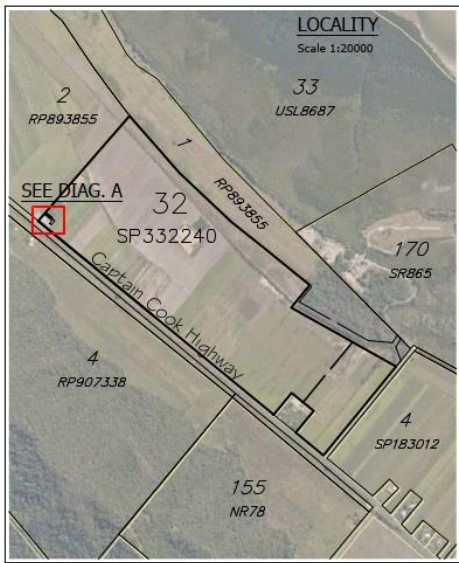

PROPOSED RURAL ACTIVITY
in Lot 32 on SP332240
Locality of Killaloe
Douglas Shire Council

Date: 6/08/2025	
Scale: 1:400	A3
Drawn: WCHO	
Job No: 35437/007-01	
Plan No: 35437/005 A	

braziermotti.com.au

SURVEYING
TOWNPLANNING
PROJECTMANAGEMENT
MAPPING&GIS



braziermotti

This plan is conceptual and for discussion purposes only. All areas, dimensions and land uses are preliminary, subject to investigation, survey, engineering, and Local Authority and Agency approvals.