

Our Ref: P81617
Your Ref: MCUI 1331 / 2016

29 March 2016

Chief Executive Officer
Douglas Shire Council
PO Box 723
Mossman QLD 4873

Attention: Neil Beck

Dear Neil,

**Information Response - Material Change of Use
Extension to Business Facilities (Funeral Parlour and Cremator)**

I am pleased to provide this information response for the Material Change of Use for the Extension to the existing Business Facilities (Funeral Parlour).

The up to date site plan is attached, showing:

- Vehicle access locations to the site
- Location of onsite parking and manoeuvring areas
- Landscape areas

Note that the plan now shows the flue for the cremator located behind the shed, rather than on the driveway, which improves manoeuvrability on the site.

The Funeral Home is already operating from that site. The current operator purchased the existing funeral home in May 2008 from Crimmins Family Funerals. The premises is used for the administration of funerals and as a base for transporting bodies to an offsite funeral service or the cemetery. Services are not held on site. The applicant is available to meet onsite, with Council's planners to show you around the site and provide a description of the business on the site.

This information represents the full response to Council's information request and the public notification for the use will commence by 1 April 2016. Could you **please provide** the adjoining owner information.

If you require any further information please do call me.

Yours faithfully,

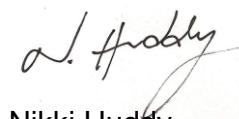

Nikki Huddy
**Managing Director
Planz Town Planning**

Att: Amended Site Plan 312.15 Rev A

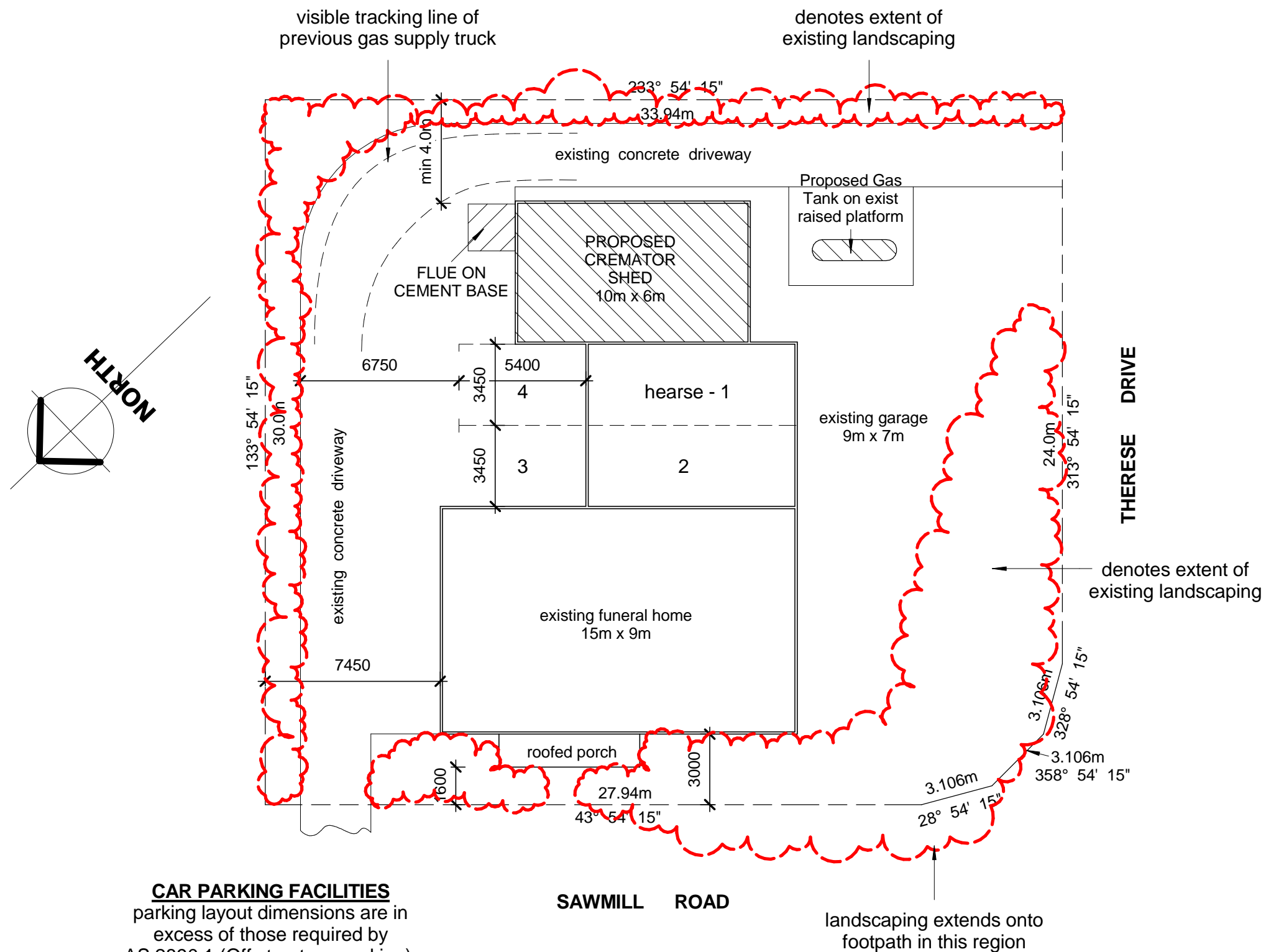

CAR PARKING FACILITIES
parking layout dimensions are in excess of those required by AS 2890.1 (Off street car parking), based on Class 4 parking facilities (disabled) and Figure 2.2 for 90° layout, - please refer to pages 7 and 10 of AS 2890.1 for referenced criteria

1 Site Plan
1 : 200

ALLOTMENT AREA 1009m²
LANDSCAPED AREA 250m²
(excludes area provided on footpath)

GREG SKYRING
Design and DRAFTING Pty. Ltd.

Lic Under QBSA Act 1991 - No 1040371

11 Noli Close,
Mossman Q. 4873

Phone/Fax: (07) 40982061
Mobile: 0419212652
Email: greg@skyringdesign.com.au

PROJECT

Site Plan of Proposed Cremator Shed,
14 Sawmill Road,
L16 RP748705,
MOSSMAN

CLIENT

Mossman and Port Douglas Community
Funerals

WIND CLASS

C2

PLAN NUMBER

312-15

SHEET

1 of 1

SCALES

1 : 200

PLAN TITLE

Site Plan

DATE OF ISSUE

17.03.16

REV

A